

12TH ANNUAL
NOSC
NATIONAL OUTREACH
SCHOLARSHIP
CONFERENCE

Engaged Scholarship and Evidence-Based Practice

OCTOBER 2 - 4, 2011



Hosted by **MICHIGAN STATE UNIVERSITY**

Kellogg Hotel & Conference Center, East Lansing, MI

twitter 
hashtag
#NOSC2011

outreachscholarship.org 

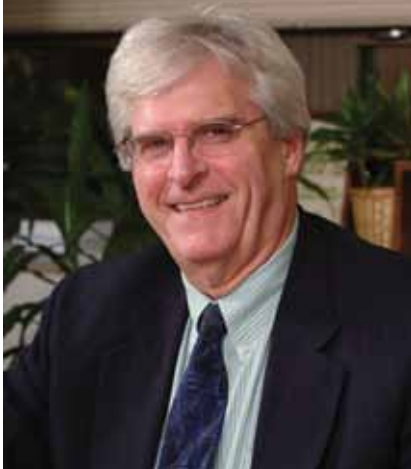

Welcome!

To the 2011 National Outreach Scholarship Conference

Welcome to the 12th Annual Meeting of the National Outreach Scholarship Conference (NOSC). If you've attended in the past, welcome back. If this is your first time, you'll find that this conference will validate your interest in the rapidly advancing field of research on community engagement scholarship—and challenge your thinking about the centrality of engagement in higher education.

This year's conference theme is *Engaged Scholarship and Evidence-Based Practice*. This theme is close to my heart as I have been strongly advocating for engaged scholarship during my tenure as associate provost for university outreach and engagement at Michigan State University and president of the National Outreach Scholarship Conference. The five tracks of this conference will explore:

- Methods and Practices of Community-Based Research and Creative Activities
- Translational Science and the Diffusion of Innovation
- Globalization and International Engagement
- Technologies as Tools for Engagement
- Leadership and Professional Development for Engaged Scholarship

We have put together a number of interesting plenary sessions with invited speakers and panelists from around the country and the world. Responding to past conference feedback from participants, we have concurrent sessions featuring workshops, symposia, and poster symposia, each of which has been extended from 60 minutes to 75 minutes to increase discussion among participants. We also have two 2-hour poster sessions and a 90 minute award ceremony honoring the regional winners of the Outreach Scholarship W.K. Kellogg Foundation Community Engagement Award and announcing the finalists for the national C. Peter Magrath University/Community Engagement Award.

I look forward to interacting with you throughout the course of these three days. I hope that you will find this year's conference to be as rewarding and informative as it is enjoyable.

Sincerely,

A handwritten signature in black ink that reads "Hiram E. Fitzgerald".

Hiram E. Fitzgerald

President, National Outreach Scholarship Conference
Associate Provost for University Outreach and Engagement
University Distinguished Professor, Department of Psychology
Michigan State University

National Outreach Scholarship Conference

Member Institutions Representatives



Auburn University

Royrickers Cook
Assistant Vice President for University Outreach



Purdue University

Victor L. Lechtenberg
Vice Provost for Engagement



Colorado State University

Louis E. Swanson
Vice President for Engagement



Texas Tech University

Valerie Osland Paton
Vice Provost for Planning and Assessment



East Carolina University

J. Ted Morris
Associate Vice Chancellor of Engagement, Innovation and Economic Development



University of Alabama

Samory T. Pruitt
Vice President for Community Affairs



Michigan State University

Hiram E. Fitzgerald
Associate Provost for University Outreach and Engagement



University of Alberta

Katy Campbell
Dean and Professor, Faculty of Extension



North Carolina State University

James J. Zuiches
Vice Chancellor for Extension, Engagement and Economic Development



University of Georgia

Jennifer L. Frum
Interim Vice President for Public Service and Outreach



Ohio State University

Joyce Beatty
Senior Vice President for Outreach and Engagement



University of Kentucky

Philip A. Greasley
Associate Provost for University Engagement



Oregon State University

Scott Reed
Vice Provost for University Outreach and Engagement



University of Wisconsin Extension

Greg Hutchins
Interim Provost and Vice Chancellor



Pennsylvania State University

Craig D. Weidemann
Vice President for Outreach



Table of Contents

General Information	2
Program at a Glance	4
Preconference Workshops	8
Emerging Engagement Scholars Workshop (Day 1)	9
Emerging Engagement Scholars Workshop (Day 2)	10
Utilization-Focused Evaluation Workshop	10
Outreach and Engagement Staff Workshop	10
Perspectives on Developing Engaged Scholars Workshop	11
Detailed Program	12
Saturday, October 1	13
Sunday, October 2	13
Monday, October 3	20
Tuesday, October 4	28
Poster Presentations	32
Poster Session 1 - Sunday, October 2	33
Poster Session 2 - Monday, October 3	35
Acknowledgments	
Michigan State University Planners	40
2011 Emerging Engagement Scholars Workshop	41
2011 Outreach and Engagement Staff Workshop	42
2011 National Outreach Scholarship Conference	
National Implementation Committee	43
Floorplans - Kellogg Hotel & Conference Center	44
Map - Venue, Hotels, and Area Map	46

General Information

Conference Registration

The conference registration will be open Saturday, October 1, 7:00 a.m. – 4:00 p.m., Sunday, October 2 and Monday, October 3, 7:00 a.m. – 5:00 p.m., and Tuesday, October 4, 7:00 a.m. – 12:30 p.m. The registration table is located in the lobby area at the Kellogg Hotel & Conference Center. In addition to finding registration information, visit the registration table for all conference related questions, special requests and accommodations, and directions.

Internet

Complimentary wireless internet is available at the conference venue, the Kellogg Hotel & Conference Center, in public spaces, meeting rooms, and guest rooms.

Social Media

A Twitter hashtag (#NOSC2011) has been created to promote more active participation during the conference. We invite you to participate by tweeting your thoughts about the conference and presentations. We have also set up a NOSC Facebook page and a LinkedIn account. We encourage you to find and make connections with colleagues from across the nation and the world by interacting within these online communities. On Facebook or LinkedIn, search “National Outreach Scholarship Conference.”

Speakers’ Preparation Room

The Speakers’ Preparation Room is located on the Garden Level of the Kellogg Hotel & Conference Center, room 93 (in the reception area for University Outreach and Engagement, in the classroom located at the back). This space is available for the duration of the conference to help presenters as they finalize preparations for their presentations. It is equipped with computers, a printer, internet access, and refreshments. The room will be available Sunday, October 1 – Monday, October 3, 7:30 a.m. – 5:00 p.m. and Tuesday, October 4, 7:30 a.m. – 2:00 p.m.

Breaks and Refreshments

Hot and cold beverages will be available during breaks in the Centennial Room. See the Program at a Glance for break times.

Restrooms

Restrooms are located on the main corridor of the Kellogg Hotel & Conference Center. See the Kellogg floor plan in the back of this program for the location of other restrooms.

Disability Access

The Kellogg Hotel & Conference Center is fully wheelchair accessible. If you need special accommodations, please visit the conference registration table.

Parking

Guests of the Kellogg Hotel & Conference Center can park their cars for free at the ramp. If you are driving but not staying at the Kellogg Center, daily rates are \$1.00 per hour up to \$8.00 for the day. MSU parking passes cannot be used at the Kellogg Center ramp. MSU faculty and staff can park in lot 67 close to Jenison Field House, lot 66 near the side of the Kellogg Center ramp, or lot 63E in front of the Breslin Center.



Transportation

Conference Shuttle

A complimentary shuttle bus will travel between the Kellogg Hotel & Conference Center and the Radisson Hotel Lansing. The shuttle bus will also make special trips to some other area attractions, including downtown East Lansing. Visit the conference registration table for details about special trips. The shuttle bus will operate its regular service between hotels Saturday, October 1, to Monday, October 3, 6:30 a.m. – 10:00 p.m. It will also operate 6:30 a.m. – 2:30 p.m. on Tuesday, October 4.

Public Transportation

Public transportation is available by CATA bus. Route maps and schedules are available at the NOSC registration table or visit the CATA website at cata.org.

Taxis

Visit the NOSC registration table for a list of local taxi companies or the NOSC website at: outreachscholarship.org.

Walking and Bike Tours

Walking Tour

Tour the MSU Horticulture Gardens and see up to 14 acres of gardens and learn about new annuals, perennials, ornamental grasses, shrubs and trees, and their uses in the landscape. In 1879, Professor William James Beal planted 20 common plants in bottles starting the longest continuously monitored experiment in the world. This two hour tour will walk the scenic Red Cedar River and feature the Beal Gardens where descriptive labels provide information about the plants displayed in the four main collections. A sign-up sheet will be available at the registration table. Participants will congregate at the Centennial Room prior to the tour. Tour will be Sunday, October 2, 6:30 p.m.

Bike Tour

Learn about the history of the MSU area, see the sites, take lots of photos, and make new friends. Bike rentals for guided tour and self guided tours will be offered on a first come first serve basis. Bring a helmet and/or lock for discounted rate. Get your reservation early by emailing height and/or bike size to Dwight Washington at washin18@msu.edu. Monday, October 3, 6:30 p.m.

Bookstore

The Barnes & Noble Bookstore in East Lansing has set up an area featuring books about university engagement and the scholarship of engagement. Be sure to visit the bookstore located in the Galaxy room.

Sustainability

We have made an effort to reduce the NOSC footprint on the environment by making available canvas reusable totes and canvas neck wallets. We also have reduced the size of this program booklet by omitting the presentation abstracts. Please visit the NOSC website for abstracts: outreachscholarship.org



2011 Program at a Glance

Friday, September 30

2:00 p.m. – 5:30 p.m.	Emerging Engagement Scholars Workshop (Day 1) • Room: Centennial C
6:30 p.m. – 8:30 p.m.	Emerging Engagement Scholars Workshop Dinner • Room: Centennial A/B

Saturday, October 1

7:00 a.m. – 4:00 p.m.	Registration • Central Lobby
7:00 a.m. – 5:15 p.m.	Emerging Engagement Scholars Workshop (Day 2) • Room: 105
8:30 a.m. – 4:30 p.m.	Utilization-Focused Evaluation Workshop • Room: Lincoln
9:00 a.m. – 4:30 p.m.	Joint NOSC Board of Directors and Institutional Members Meeting <i>(by invitation only)</i> • Room: 106
10:00 a.m. – 4:00 p.m.	Outreach and Engagement Staff Workshop • Room: 103
1:00 p.m. – 5:00 p.m.	Perspectives on Developing Engaged Scholars Workshop • Room: 104
5:30 p.m. – 7:30 p.m.	Opening Reception • Wharton Center for Performing Arts

Sunday, October 2

7:00 a.m. – 5:00 p.m.	Registration • Central Lobby
7:30 a.m. – 8:00 a.m.	Continental Breakfast • Room: Centennial A/B/C
8:00 a.m. – 9:15 a.m.	Plenary Session 1: Methods and Practices of Community-Based Research and Creative Activities • Room: Big Ten A/B
9:30 a.m. – 10:45 a.m.	Concurrent Session 1
10:45 a.m. – 11:15 a.m.	Break • Room: Centennial A/B/C
11:15 a.m. – 12:30 p.m.	Concurrent Session 2
12:30 p.m. – 1:15 p.m.	Lunch • Room: Big Ten A/B
1:15 p.m. – 2:45 p.m.	Outreach Scholarship / W.K. Kellogg Foundation Engagement Award Presentations • Room: Big Ten A/B
2:45 p.m. – 3:15 p.m.	Break • Room: Centennial A/B/C
3:15 p.m. – 4:30 p.m.	Plenary Session 2: Translational Science and the Diffusion of Innovation • Room: Big Ten A/B
3:15 p.m. – 4:30 p.m.	Magrath Award Selection Committee Session • Room: Michigamme
4:30 p.m. – 6:00 p.m.	International Adult and Continuing Education Hall of Fame Symposium • Room: 105
4:30 p.m. – 6:30 p.m.	Poster Session 1 with Reception • Room: Big Ten C
7:00 p.m. – 9:00 p.m.	NOSC Institutions Presidents/Chancellors Dinner <i>(by invitation only)</i> • Cowles House
7:00 p.m. – 9:00 p.m.	NOSC Implementation Committee Dinner <i>(by invitation only)</i> • Clara's Lansing Station
7:00 p.m. – 9:00 p.m.	Outreach and Engagement Staff Workshop Networking Reception • Dublin Square Irish Pub



Monday, October 3

7:00 a.m. – 5:00 p.m.	Registration • Central Lobby
7:00 a.m. – 8:00 a.m.	International Adult and Continuing Education Hall of Fame / Emerging Engagement Scholars Breakfast (<i>by invitation only</i>) • Room: 103
7:00 a.m. – 8:00 a.m.	Journal of Higher Education Outreach and Engagement Editorial Board Breakfast (<i>by invitation only</i>) • Room: 104
7:30 a.m. – 8:00 a.m.	Continental Breakfast • Room: Centennial A/B/C
8:00 a.m. – 9:15 a.m.	Plenary Session 3: Leadership and Professional Development for Engaged Scholarship • Room: Big Ten A/B
9:30 a.m. – 10:45 a.m.	Concurrent Session 3
10:45 a.m. – 11:15 a.m.	Break • Room: Centennial A/B/C
11:15 a.m. – 12:30 p.m.	Concurrent Session 4
12:30 p.m. – 1:15 p.m.	Lunch • Room: Big Ten A/B
1:15 p.m. – 2:30 p.m.	Plenary Session 4: Technologies as Tools for Engagement • Room: Big Ten A/B
2:30 p.m. – 3:00 p.m.	Break • Room: Centennial A/B/C
3:00 p.m. – 4:15 p.m.	Concurrent Session 5
4:15 p.m. – 6:15 p.m.	Poster Session 2 with Reception • Room: Big Ten C
6:30 p.m. – 8:30 p.m.	Annual NOSC Institutional Members Meeting with Reception (<i>by invitation only</i>) • MSU Museum

Tuesday, October 4

7:00 a.m. – 12:30 p.m.	Registration • Central Lobby
7:30 a.m. – 8:00 a.m.	Continental Breakfast • Room: Centennial A/B/C
8:00 a.m. – 9:15 a.m.	Plenary Session 5: Globalization and International Engagement • Room: Big Ten A/B
9:30 a.m. – 10:45 a.m.	Concurrent Session 6
10:45 a.m. – 11:15 a.m.	Break • Room: Centennial A/B/C
11:15 a.m. – 12:30 p.m.	Concurrent Session 7
12:30 p.m. – 1:15 p.m.	Poster Awards, Closing Remarks, and 2012 Invitation (<i>with boxed lunch</i>) • Room: Big Ten A/B
1:15 p.m. – 2:15 p.m.	NOSC Implementation Committee Debriefing (<i>by invitation only</i>) • Room: Red Cedar B

Scan this QR Code to get
the Program at a Glance on your mobile device



National Outreach Scholarship Conference

2011 Program at a Glance

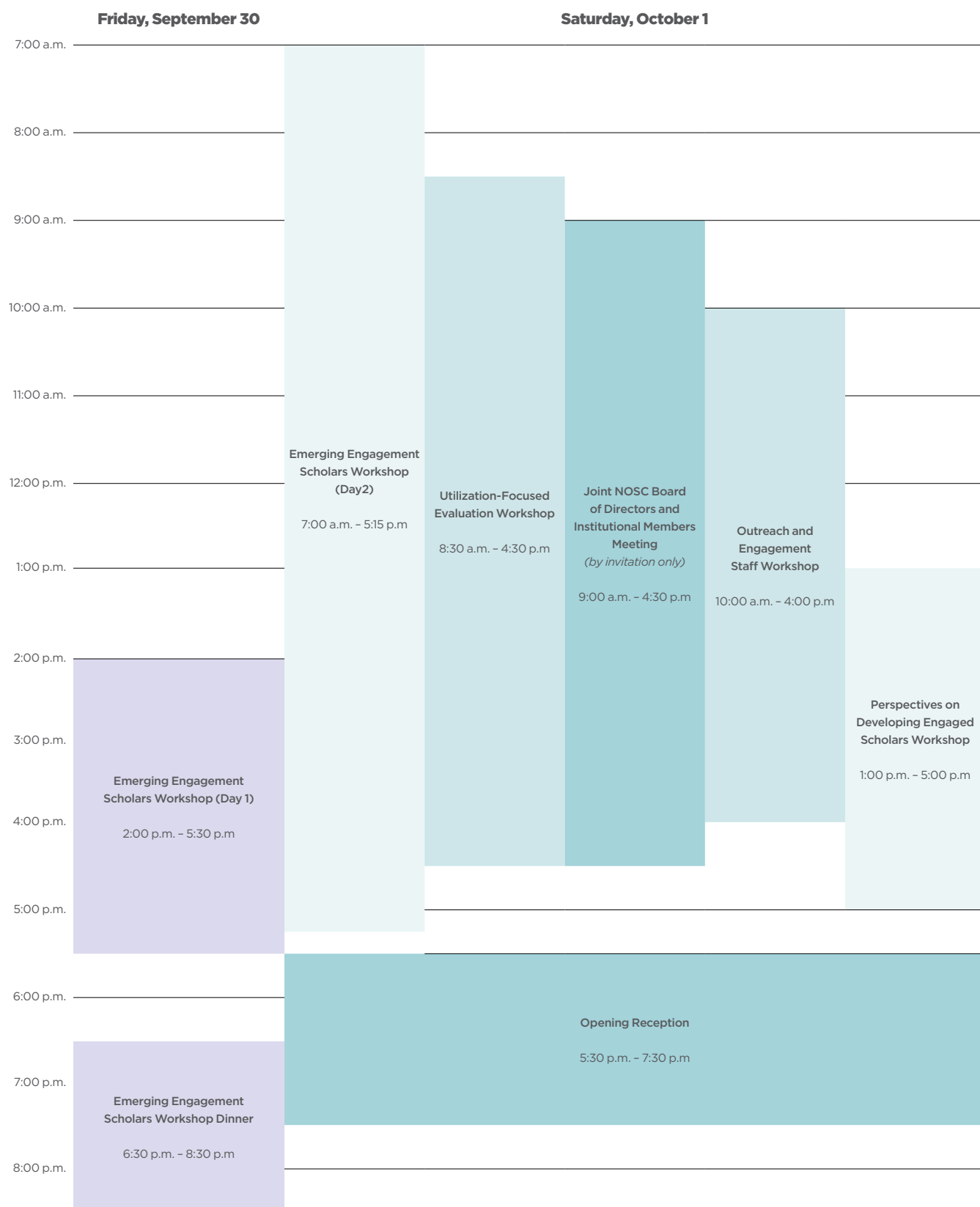

	Sunday, October 2		Monday, October 3		Tuesday, October 4	
7:00 a.m.				IACEHOF / EESW Breakfast <i>(by invitation only)</i>	JHEOE Editorial Board Breakfast <i>(by invitation only)</i>	7:00 a.m.
8:00 a.m.	Continental Breakfast 7:30 a.m. – 8:00 a.m.		Continental Breakfast 7:30 a.m. – 8:00 a.m.	7:00 a.m. – 8:00 a.m.	7:00 a.m. – 8:00 a.m.	8:00 a.m.
9:00 a.m.	Plenary Session 1: Methods and Practices of Community-Based Research and Creative Activities 8:00 a.m. – 9:15 a.m.		Plenary Session 3: Leadership and Professional Development for Engaged Scholarship 8:00 a.m. – 9:15 a.m.		Plenary Session 5: Globalization and International Engagement 8:00 a.m. – 9:15 a.m.	9:00 a.m.
10:00 a.m.	Concurrent Session 1 9:30 a.m. – 10:45 a.m.		Concurrent Session 3 9:30 a.m. – 10:45 a.m.		Concurrent Session 6 9:30 a.m. – 10:45 a.m.	10:00 a.m.
11:00 a.m.	Break 10:45 a.m. – 11:15 a.m.		Break 10:45 a.m. – 11:15 a.m.		Break 10:45 a.m. – 11:15 a.m.	11:00 a.m.
12:00 p.m.	Concurrent Session 2 11:15 a.m. – 12:30 p.m.		Concurrent Session 4 11:15 a.m. – 12:30 p.m.		Concurrent Session 7 11:15 a.m. – 12:30 p.m.	12:00 p.m.
1:00 p.m.	Lunch 12:30 p.m. – 1:15 p.m.		Lunch 12:30 p.m. – 1:15 p.m.		Poster Awards, Closing Remarks, and 2012 Invitation <i>(with boxed lunch)</i> 12:30 p.m. – 1:15 p.m.	1:00 p.m.
2:00 p.m.	Outreach Scholarship / W.K. Kellogg Foundation Engagement Award Presentations 1:15 p.m. – 2:45 p.m.		Plenary Session 4: Technologies as Tools for Engagement 1:15 p.m. – 2:30 p.m.		NOSC Implementation Committee Debriefing <i>(by invitation only)</i> 1:15 p.m. – 2:15 p.m.	2:00 p.m.
3:00 p.m.	Break 2:45 p.m. – 3:15 p.m.		Break 2:30 p.m. – 3:00 p.m.			3:00 p.m.
4:00 p.m.	Magrath Award Selection Committee Session 3:15 p.m. – 4:30 p.m.	Plenary Session 2: Translational Science and the Diffusion of Innovation 3:15 p.m. – 4:30 p.m.	Concurrent Session 5 3:00 p.m. – 4:15 p.m.			4:00 p.m.
5:00 p.m.	International Adult and Continuing Education Hall of Fame Symposium 4:30 p.m. – 6:00 p.m.	Poster Session 1 with Reception 4:30 p.m. – 6:30 p.m.	Poster Session 2 with Reception 4:15 p.m. – 6:15 p.m.			5:00 p.m.
6:00 p.m.						6:00 p.m.
7:00 p.m.			Annual NOSC Institutional Members Meeting with Reception <i>(by invitation only)</i> 6:30 p.m. – 8:30 p.m.			7:00 p.m.
8:00 p.m.	NOSC Institutions Presidents/ Chancellors Dinner <i>(by invitation only)</i> 7:00 p.m. – 9:00 p.m.	NOSC Implementation Committee Dinner <i>(by invitation only)</i> 7:00 p.m. – 9:00 p.m.	Outreach and Engagement Staff Workshop Reception 7:00 p.m. – 9:00 p.m.			8:00 p.m.

Preconference Workshops

An exciting opportunity associated with 2011 National Outreach Scholarship Conference is the workshops that are taking place prior to the conference. Workshops are geared to a variety of audiences:

- **Emerging Engagement Scholars Workshop**
For early career faculty and graduate students
- **Outreach and Engagement Staff Workshop**
For university staff and community members
- **Perspectives on Developing Engaged Scholars**
For university leaders and scholars
- **Utilization-Focused Evaluation**
Facilitated by Michael Quinn Patton, Ph.D.
For researchers and community members



Emerging Engagement Scholars Workshop (Day 1)

This intensive professional development program provides advanced doctoral students and early career faculty with background literature, facilitated discussion, mentoring, and presentations designed to increase their knowledge and enhance their practice of community engaged scholarship. Applicants were nominated to be part of this workshop.

Executive Director, Children, Youth, and Family Consortium; Associate Professor, Pediatrics, University of Minnesota

Session Notes

[illegible]

Saturday, October 1

7:00 a.m. – 4:00 p.m.

Registration

7:00 a.m. – 5:15 p.m.

Emerging Engagement Scholars Workshop (Day 2)

Room: 105

This intensive professional development program provides advanced doctoral students and early career faculty with background literature, facilitated discussion, mentoring, and presentations designed to increase their knowledge and enhance their practice of community engaged scholarship. Applicants were nominated to be part of this workshop.

(View Page 9 for a list of Presenters and Mentors)

8:30 a.m. – 4:30 p.m.

Utilization-Focused Evaluation Workshop

Room: Lincoln

Instructor:

Michael Quinn Patton, Ph.D.

Founder & Director, Utilization-Focused Evaluation
and independent evaluation consultant

Utilization-Focused Evaluation begins with the premise that evaluations should be judged by their utility and actual use; therefore, evaluators should facilitate the evaluation process and design any evaluation with careful consideration of how everything that is done, *from beginning to end*, will affect use. Use concerns how real people in the real world apply evaluation findings and experience the evaluation process. Therefore, the *focus* in utilization-focused evaluation is on intended use by intended users.

Utilization-focused evaluation is a process for helping primary intended users select the most appropriate content, model, methods, theory, and uses for their particular situation. Situational responsiveness guides the interactive process between evaluator and primary intended users. A psychology of use undergirds and informs utilization-focused evaluation: intended users are more likely to use evaluations if they understand and feel ownership of the evaluation process and findings; they are more likely to understand and feel ownership if they've been actively involved; by actively involving primary intended users, the evaluator is training users in use, preparing the groundwork for use, and reinforcing the intended utility of the evaluation every step along the way.

**MICHIGAN STATE
UNIVERSITY**

University Outreach
and Engagement
Community Evaluation
and Research Collaborative

MAE
Michigan Association for Evaluation

This session is sponsored by
the Community Evaluation and Research
Collaborative of University Engagement at
Michigan State University and the Michigan
Association for Evaluation.

10:00 a.m. – 4:00 p.m.

Outreach and Engagement Staff Workshop

Room: 103

The Outreach and Engagement Staff Workshop is designed for university staff members who, in roles distinct from those of tenure-track faculty, facilitate and manage ongoing projects, programs, services, research and relationships with community partners. These professionals span the boundaries between campus and community and have an emerging professional identity and a unique set of strengths and challenges that will be addressed in this workshop. This workshop is led by peer practitioners with keynotes by:

Lorilee Sandmann

Professor, Department of Adult Education
University of Georgia

Randy Stoecker

Professor, Community and Environmental Sociology
University of Wisconsin-Madison

Room: 104

Presenters:

Virginia Polytechnic Institute and State University

Michigan State University

East Carolina University

University of North Carolina

Association of Public and Land-grant Universities' (APLU) Transformational Regional Engagement Toolkit

This image shows a single sheet of white paper with horizontal ruling lines. The lines are evenly spaced and run across the width of the page. There are no margins, text, or other markings on the paper.

Detailed Program

Schedule of Plenary and Concurrent Sessions

The 2011 National Outreach Scholarship Conference features a number of interesting plenary sessions with invited speakers and panelists from around the country and the world. We also have concurrent sessions featuring workshops, symposia, and poster symposia, each of which has been extended from 60 minutes to 75 minutes to increase discussion among participants. In addition, we have two 2-hour poster sessions and a 90 minute award ceremony honoring the regional winners of the Outreach Scholarship W.K. Kellogg Foundation Community Engagement Award and announcing the finalists for the national C. Peter Magrath University/Community Engagement Award.

The five tracks of this conference explore:

- Methods and Practices of Community-Based Research and Creative Activities
- Translational Science and the Diffusion of Innovation
- Globalization and International Engagement
- Technologies as Tools for Engagement
- Leadership and Professional Development for Engaged Scholarship



5:30 p.m. – 7:30 p.m.

Opening Reception

Wharton Center for Performing Arts

The event will feature:

- A welcome to the meeting by Hiram E. Fitzgerald, President, Board of Directors, National Outreach Scholarship Conference
- A welcome to campus by Kim A. Wilcox, Provost and Vice President for Academic Affairs, Michigan State University
- The presentation of the Outreach Scholarship W.K. Kellogg Foundation Engagement Award recognitions by Mortimer H. Neufville, Interim President, University of Maryland Eastern Shore
- A performance by the Grammy Award winning Michigan State University Children's Choir
- The performance will be immediately followed by a reception featuring Michigan foods and beverages.

Sunday, October 2

7:00 a.m. – 5:00 p.m.

Registration

7:30 a.m. – 8:00 a.m.

Continental Breakfast

Room: Centennial A/B/C

8:00 a.m. – 9:15 a.m.

Plenary Session 1: Methods and Practices of Community-Based Research and Creative Activities

Room: Big Ten A/B

A panel of researchers will discuss the state of the evidence base related to the benefits of engaged scholarship (inclusive of engaged research and creative activity) for community and university partners.

Related questions include:

- What kinds of evidence counts, for whom, and who decides?
- What are the implications of delayed benefits for gathering such evidence?
- What engagement practices and processes are most likely to result in shared benefits for community and university partners?
- What methods would be most fruitful in establishing the evidence base regarding the benefits of engaged scholarship and the relationship between engaged processes/practices and outcomes?

Convener:

Valerie Osland Paton

Vice Provost for Planning and Assessment
Interim Dean, University College
Texas Tech University

Valerie Osland Paton, Ph.D., leads institutional effectiveness in administrative and academic affairs at Texas Tech University. She supervises the Office of Planning and Assessment, and the Quality Enhancement Plan/TTU Ethics Center. Dr. Paton represents Texas Tech as the institutional liaison to SACSCOC, member of THECB Peer Accountability Group for Value Added, member of the Executive Committee for the Council on Engagement and Outreach of the Association of Public and Land-grant Universities, and sponsoring partner for the National Outreach Scholarship Conference. Dr. Paton serves as a faculty member in the higher education program in TTU's College of Education. Her research interests include higher education policy and practice, engagement, planning and assessment. She is a co-PI for an Hispanic Serving Institutions STEM grant with El Centro College, TTU's Department of Biology, and the TTU Center at Junction; PI for a Suder Foundation grant on first generation students; and PI on a TTU Graduate School Grant for Growing Graduate Programs.

Presenters:

Daniel F. Perkins

Professor, Family and Youth Resiliency and Policy; Director, Penn State Cooperative Extension Children, Youth, and Families Are Resilient Initiative
Pennsylvania State University

Daniel Perkins, Ph.D., is engaged in teaching, research, and outreach through the Penn State Cooperative Extension Service. His scholarship involves the integration of practice and research into three major foci: (1) Positive Youth Development – decrease risks and increase skills and competencies of youth through evidence-based programs; (2) Healthy Family Development – increase resiliency through evidence-based, strength-based educational programming; and (3) Community Collaboration – promote strategies for mobilizing communities in support of children, youth, and families. His most recent effort is the development of the Clearinghouse for Military Family Readiness, which is designed to build science-based practice for promoting principles of effectiveness in evidenced-based programming to enhance military family readiness.

(continued on next page)

8:00 a.m. – 9:15 a.m.

Plenary Session 1 (continued)

Room: Big Ten A/B

Nancy K. Franz

Associate Dean for Extension and Outreach for Families and 4-H Youth;
 Director, ISU Extension to Families
 Iowa State University

Nancy Franz, Ph.D., serves as associate dean for Extension and Outreach for Families and 4-H Youth in the College of Human Sciences, and the director of ISU Extension to Families at ISU. She has served as an Extension agent, specialist, graduate student, and administrator over her life with Extension systems in Wisconsin, New York, New Hampshire, Virginia, and Iowa.

Jonathan K. London

Assistant Professor, Human and Community Development;
 Director, UC Davis Center for Regional Change
 University of California — Davis

Jonathan London, Ph.D., is the director of the Center for Regional Change at UC Davis, which brings together faculty, students, and communities to collaborate on innovative research to create just, sustainable, and healthy regional change in California's Central Valley and Sierra Nevada. The Center connects university research with planners, land managers, non-profits, environmentalists, communities and social service providers; links university knowledge with state and local governments to develop policies that affect regional change; and works across boundaries, leverages resources, builds unity and creates programs to address unmet needs. Dr. London conducts research on rural community development and environmental justice and serves as an assistant professor in the Department of Human and Community Development. He has extensive leadership experience in nonprofit management, participatory research, and community engagement.

MICHIGAN STATE
 UNIVERSITY

Extension

This session is sponsored by
 Michigan State University Extension.

9:30 a.m. – 10:45 a.m.

Concurrent Session 1

Symposium 1: Bringing the Inside Onside: Canadian Perspectives on Advancing CES

Room: 103

Rhonda Lenton, York University; **Budd L. Hall**, University of Victoria;
Katy Campbell, University of Alberta

Symposium 2: Community Voices in University-Community Engagement

Room: 104

Angela Waters Austin, Ingham Lansing Community Coalition for Youth;
Wendy Lull, Seacoast Science Center; **Jason Lee**, Detroit Area Pre-College Engineering Program;
Malik G. Bankston, the Kingsley Association; convened by **Janet Griffith**, University of Alabama

Symposium 3: Ethnographers' Experiences with Long-term Community Engagement and Collaborative Documentation

Room: 105

Ann Kingsolver, University of South Carolina; **Sasikumar Balasundaram**, University of South Carolina;
Mary Anglin, University of Kentucky; **Susan Brin Hyatt**, Indiana University- Purdue University
 Indianapolis; **Hsain Ilahiane**, University of Kentucky

Workshop 1: Revolutionizing Human Services Delivery with Community Collaboration, Inc.

Room: Riverside (on lower level)

Anne Kaplan, Northern Illinois University; **Allan Barsema**, Northern Illinois University; **Dan Ihm**,
 Northern Illinois University; **Rena Cotsones**, Northern Illinois University

Workshop 2: Using CBPR to Improve Environmental Health in an Urban Community

Room: 101

Rosemary Valedes Chaudry, Ohio State University; **Barbara J. Polivka**, Ohio State University;
J. Mac Crawford, Ohio State University; **Randi L. Love**, Ohio State University;
Robyn S. Wilson, Ohio State University; **Susan Colbert**, Ohio State University

Workshop 3: Creating a Framework to Maximize the Impact of Community-Based Projects

Room: 106

Mary Beckman, University of Notre Dame; **Naomi G. Penney**, University of Notre Dame

Workshop 4: Teaching Across Borders: Lessons Learned from a US-German Teacher Exchange

Room: Heritage

Angelika N. Kraemer, Michigan State University

Workshop 5: Virtual Success: MSU Extension and the National eXtension

Room: 62 (on lower level)

Michelle S. Rodgers, Michigan State University; **Terry Meisenbach**, eXtension

9:30 a.m. – 10:45 a.m.

Concurrent Session 1 (continued)

Poster Symposium 1: Economic Development

Room: Michigamme (on lower level)

Creating Practical Knowledge and Tools for Transformational Regional Engagement

Jeri Childers, Virginia Tech; James Woodell, Pennsylvania State University

The Economic Impact of Community Engagement - University of Delaware

Lynnette Overby, University of Delaware

Role of Institutional Partnerships in Community Outreach and Scholarship

Jeff Sherman, Oregon State University; Jon Carnahan, Tillamook Bay Community College; Mark Labhart, Tillamook County

Community Economic and Entrepreneurial Development (ExCEED): Expanding the Engagement Paradigm

Mary Leuci, University of Missouri; Sharon A. Gulick, University of Missouri; Letitia K. Johnson, University of Missouri; Willis Mushrush, University of Missouri; Donna Glover Brown, City of Higginsville; Patsy Hambleton, Gainesville R-V High School

Engaging Undergraduate Students: A Collaborative Approach to University/Community Partnerships

Richard Harnish, Pennsylvania State University at New Kensington; Kevin J. Snider, Pennsylvania State University at New Kensington; Samantha L. Polons, Pennsylvania State University at New Kensington; Amanda E. Polons, Pennsylvania State University at New Kensington

Economic Engagement at Public Universities: A Framework for Definition, Assessment

James Woodell, Pennsylvania State University; Thomas Perorazio, University of Michigan

The “New Economy” Policy Context and Public Research Universities’ Engagement

James Woodell, Pennsylvania State University

10:45 a.m. – 11:15 a.m.

Break • Room: Centennial A/B/C

11:15 a.m. – 12:30 p.m.

Concurrent Session 2

Symposium 4: Cultural Contexts for Community-Based Research

Room: 104

Daniel Wildcat, Haskell Indian Nations University; Frederick Leong, Michigan State University; Francisco Villarruel, Michigan State University; Carl Taylor, Michigan State University; convened by Gordon Henry, Michigan State University

Symposium 5: Technology for Engagement with High School STEM Students and Teachers

Room: 103

Lynn Sametz, University of North Carolina Greensboro; Felicia Chong, Michigan Technological University; Brittany Collier-Gibson, Ohio State University-Lima; Jason D. Lee, Detroit Area Pre-College Engineering Program (DAPCEP)

Symposium 6: Arts, Culture and Community Action

Room: 105

Living Reciprocity: Harnessing Individual Power To Sustain Partnerships

Eric Malm, Cabrini College; Stephen Eberle, Cabrini College; Melissa Terlecki, Cabrini College; David Dunbar, Cabrini College

Community Culture Fest: Building Communities through Cultural Appreciation

Brice Miller, University of Alabama; Whitney Jones, University of Alabama; Chris Hall, Tuscaloosa Housing Authority

Launching Engagement with the Community Arts Café

Mary Leuci, University of Missouri; Shelley Bush Rowe, University of Missouri; Suzanne Burgoyne, University of Missouri

Workshop 6: The University as Network Weaver

Room: Heritage

Scott Hutcheson, Purdue Center for Regional Development

(continued on next page)

11:15 a.m. – 12:30 p.m.

Concurrent Session 2 (continued)

Workshop 7: Pervasive and Deep: University Structures and Paradigms to Enhance Engagement

Room: 101

Jay W. Brandenberger, University of Notre Dame; **James Frabutt**, University of Notre Dame; **Stuart Greene**, University of Notre Dame

Workshop 8: Promoting Utilization of Evaluation Findings: Lessons from a Statewide Evaluation

Room: 106

Pennie G. Foster-Fishman, Michigan State University; **Joan Blough**, Early Childhood Investment Corporation; **Alissa Parks**, Early Childhood Investment Corporation; **Charles Collins**, Michigan State University; **Mara Stein**, Michigan State University; **Kalli Decker**, Michigan State University

Workshop 9: Building 21st Century Resilience Through Creative Engagement and Technology

Room: Riverside (on lower level)

Theresa M. Bernardo, Michigan State University; **Mark V. Sullivan**, Michigan State University; **Bill Hart-Davidson**, Michigan State University; **Dean Rehberger**, Michigan State University

Poster Symposium 2: Student Engagement

Room: Michiganme (on lower level)

Overseas Service-Learning Projects: Bridging Local and International Communities

Anna Helm, George Washington University

Reflections on Graduate Community Engagement

Antonio Vasquez, Michigan State University

Service-Learning/Civic Engagement at a Large University: Linking Quality with Quantity

Nicole C. Springer, Michigan State University;
Karen McKnight Casey, Michigan State University

A Collaborative Learning Approach For Community-Based Research Through Service-Learning

Jacob du Plessis, Stellenbosch University;
Antoinette R. Smith-Tolken, Stellenbosch University

Undergraduates from Underrepresented Groups Engaging Living and Historical Communities

George Daniels, University of Alabama; **Thomas Potter**, University of Alabama;
Isabella Morales, University of Alabama; **Yolanda Barnes**, University of Alabama;
Lisa Elizonda, University of Alabama

Undergraduates Considering the Community in Cancer and Health Research

Heather Pleasants, University of Alabama; **Jasmin Bush**, University of Alabama; **Emberly Jay**, University of Alabama; **Patricia Davis**, University of Alabama

Designing and Implementing an Interdisciplinary Undergraduate Community-Based Research Course

Patrice Mettauer, University of New Hampshire at Manchester;
Alison Kolbe Paglia, University of New Hampshire at Manchester

12:30 p.m. – 1:15 p.m.

Lunch

Room: Big Ten A/B

1:15 p.m. – 2:45 p.m.

Outreach Scholarship / W.K. Kellogg Foundation Engagement Award Presentations

Room: Big Ten A/B

Community outreach initiatives at Michigan State University, Montana State University, Pennsylvania State University, and the University of Tennessee – Knoxville have been selected as regional winners of the 2011 Outreach Scholarship/W.K. Kellogg Foundation Engagement Award and are finalists for the C. Peter Magrath University/Community Engagement Award. Each finalist will present their initiative. For project descriptions, see the Award booklet that accompanies this program book.

2:45 p.m. – 3:15 p.m.

Break • Room: Centennial A/B/C

Plenary Session 2: Translational Science and the Diffusion of Innovation

Room: Big Ten A/B

As a result of the current economic downturn, there has been considerable interest in how universities may contribute to improving the economic health of nations, regions, and neighborhoods. A panel of university leaders will share its insights into the importance of leveraging university-based research findings and products in support of the public good, with a particular focus on economic development. Models for thinking about the role of universities in regional economies and community prosperity will be discussed and examples of institutions attempting to actively address these matters will be explored.

Convener:

James J. Zuiches

Vice Chancellor for Extension, Engagement, and Economic Development
North Carolina State University

James J. Zuiches, Ph.D., has led North Carolina State University's Office of Extension, Engagement, and Economic Development since 2006. In this role, he has applied the economic development industry cluster model to connect NC State to state and regional business growth and recruitment priorities. Prior to coming to NC State, Dr. Zuiches was a faculty member and administrator at Michigan State University, Cornell University, and Washington State University. He also served as a grant-making program officer for the National Science Foundation and W.K. Kellogg Foundation. Dr. Zuiches is a fellow of the American Association for the Advancement of Science (AAAS). He serves as a director on several boards, including the N.C. Agromedicine Institute, the Urban Serving Universities Coalition, the National Outreach Scholarship Consortium, Triangle Tomorrow, and the Food Systems Leadership Institute. He also served on the U.S. Department of Agriculture's National Agriculture, Research Extension, Education and Economics Advisory Board (2004-2008). Dr. Zuiches has presented two dozen papers in the U.S. and at international Triple Helix conferences, on such topics as the university's accelerators of innovation, economic cluster development strategies, public/private partnerships, and the impact of seed grants on faculty success.

Presenters:

Luis M. Proenza

President
University of Akron

Luis Proenza, Ph.D., is chief executive officer of the University of Akron. He has led its transformation into a powerful engine for regional economic development, a catalyst for collaborative initiatives, and the preeminent public university in Northeast Ohio. Under his leadership, the University has undertaken community efforts to create two key enterprises: a University Park Alliance that is revitalizing a 50-block area surrounding its campus, and the \$200-million Austen BioInnovation Institute in Akron, a partnership with three area hospitals and a medical school to establish Akron as a center for biomaterials and biomedicine. Dr. Proenza has been involved in national science and technology policy matters since the 1970s when he was study director of the National Research Council – National Academy of Sciences' Committee on Vision. He has also served on the U.S. Arctic Research Commission and the President's Council of Advisors on Science and Technology, as well as being chairman of the Science and Mathematics Education Task Force and secretary of Energy Advisory Board. Recently, Dr. Proenza was appointed to the Council of the Government-University-Industry Research Roundtable of the National Academies and to the Technology Innovation Program Advisory Board for the National Institute of Standards and Technology. Prior to his appointment at Akron, Dr. Proenza was vice president for research and dean of the Graduate School at Purdue University. He also served the University of Alaska, first as vice chancellor for research and dean of the Graduate School, then as vice president for academic affairs and research.

Victor L. Lechtenberg

Vice Provost for Engagement
Purdue University

Victor Lechtenberg, Ph.D., is vice provost for engagement at Purdue University. He served as interim provost at Purdue from 2007 to 2008. Dr. Lechtenberg joined the Purdue faculty as a professor of agronomy in 1971 where he taught crop science and coordinated research until 1982. He served as associate director for the Office of Agricultural Research Programs, as the executive associate dean of agriculture, and was dean of agriculture from 1993 to 2004. He has been leading Purdue's engagement programs as vice provost for engagement since 2004. Dr. Lechtenberg is a member of several academic, professional, and scholarly societies and has written nearly 150 technical papers, approximately 50 abstracts, and 6 book chapters. He served as chair of the U.S. Department of Agriculture's national Agricultural Research, Extension, Education and Economics Advisory Board from 1996 through 2002 and is a fellow of the American Society of Agronomy and the Crop Science Society of America.

(continued on next page)

3:15 p.m. – 4:30 p.m.

Plenary Session 2 (continued)

Room: Big Ten A/B

Nancy Franklin

Director, Outreach Sustainability Initiatives
Assistant Director, Penn State Institutes of Energy and the Environment
Pennsylvania State University

Nancy Franklin, Ed.D., provides leadership for Penn State's sustainability-focused outreach and engagement. Her scholarly interest centers on institutional scale engagement and regional sustainability engagement. Currently, Dr. Franklin is serving on Penn State's Sustainability Council, which has been charged by the provost and senior vice president with the development of a comprehensive sustainability strategic plan for the university. Before coming to Penn State in 2007 she was the southside regional director of information technology at Virginia Tech where she worked to leverage the university's assets in catalyzing economic and community transformation in the economically distressed south central region of Virginia. This effort in Southside Virginia was recognized with the 2007 C. Peter Mcgrath National Engagement Award.

3:15 p.m. – 4:30 p.m.

Magrath Award Selection Committee Session

Room: Michigamme (on lower level)

4:30 p.m. – 6:00 p.m.

Symposium 7: International Adult and Continuing Education Hall of Fame

Room: 105

Organizer:

Mortimer H. Neufville

Interim President, University of Maryland Eastern Shore
Emeritus Vice President, Association of Public and Land-grant Universities
Board Member, International Adult and Continuing Education Hall of Fame (IACEHOF)

Presenters:

Lessons in Leadership

Thomas Kowalik

Director of Continuing Education and Outreach, Binghamton University

Advancing Technology: Can We Build Human Capacity?

Janet Poley

Chair, IACEHOF
CEO & President, American Distance Education Consortium

Of Piracy, Pillage and Plunder: The Moral Challenges of International Engagement

Thomas J. Sork

Professor, Adult Education and Senior Associate Dean, International and Administration
Faculty of Education, University of British Columbia

Moderator:

Marcie Boucouvalas

Board, IACEHOF
Professor and Program Director, Adult Learning and Human Resource Development
Department of Human Development
Virginia Tech/National Capital Region

Immediate Past Chair, IACEHOF:

Gary E. Miller

Executive Director, Emeritus
Pennsylvania State University World Campus

4:30 p.m. – 6:30 p.m.

Poster Session 1 with Reception

Room: Big Ten C

A full list of the posters that will be on display during this session is available on page 33

7:00 p.m. – 9:00 p.m.

NOSC Institutions Presidents/Chancellors Dinner

(by invitation only)
Cowles House

NOSC Implementation Committee Dinner
(by invitation only)
Clara's Lansing Station

Outreach and Engagement Staff Workshop Networking Reception
Dublin Square Irish Pub

This image shows a single sheet of white paper with horizontal ruling lines. The lines are evenly spaced and run across the width of the page. There are no margins, text, or other markings on the paper.

Monday, October 3

7:00 a.m. – 5:00 p.m.

Registration

7:00 a.m. – 8:00 a.m.

International Adult and Continuing Education Hall of Fame / Emerging Engagement Scholars Workshop Breakfast*(by invitation only)*

Room: 103

7:00 a.m. – 8:00 a.m.

Journal of Higher Education Outreach and Engagement Editorial Board Breakfast*(by invitation only)*

Room: 104

7:30 a.m. – 8:00 a.m.

Continental Breakfast

Room: Centennial A/B/C

8:00 a.m. – 9:15 a.m.

Plenary Session 3: Leadership and Professional Development for Engaged Scholarship

Room: Big Ten A/B

A distinguished panel will offer observations about how engaged universities address the related issues of professional development and institutional leadership in efforts aimed at creating contexts generative and supportive of community-engaged scholarship and university partnerships. Insights and recommendations will be offered from the perspectives of a university president, a university chief outreach and engagement leader, and the founder of an award-winning professional development program on community engagement.

Convener:**Philip A. Greasley**

Associate Provost for University Engagement
University of Kentucky

Phil Greasley is associate provost for university engagement at the University of Kentucky. He holds a B.A. and an M.A. in English from Northwestern University and a Ph.D. from Michigan State University. Greasley is a past international president of the Association for Continuing Higher Education and the Coalition for Lifelong Learning Organizations, and the current vice president of the National Outreach Scholarship Consortium and the Kentucky Campus Compact Advisory Board. He is also a member of the editorial boards of the *Journal of Community Engagement and Scholarship* and the *Journal of Higher Education Outreach and Engagement*. Greasley created the Kentucky Engagement Conference, which is celebrating its sixth year in 2011.

Presenters:**Judith A. Ramaley**

President
Winona State University

Judith Ramaley, Ph.D., began her service as the 14th president of Winona State University in July 2005. Prior to coming to Minnesota, Dr. Ramaley held a presidential professorship in biomedical sciences at the University of Maine and was a fellow of the Margaret Chase Smith Center for Public Policy. Previously, she was president and professor of biology at the University of Vermont, and president and professor of biology at Portland State University. Dr. Ramaley has a special interest in higher education reform and has played a significant role in designing regional alliances to promote educational cooperation, and exploring civic responsibility and the role of higher education in promoting good citizenship. She has published extensively on educational reform; science, technology, engineering, and mathematics education; and the leadership of organizational change. At the national level, Dr. Ramaley is a member of: the National Science Resource Council, the board of Second Nature, the Executive Committee of the American College and University Presidents Climate Commitment (ACUPCC), the ACUPCC Policy Subcommittee, and the American Colleges and Universities (AAC&U) Presidents' Trust. She has also served on numerous boards/taskforces/commissions, including as chair of the National Board of Campus Compact and chair of the Greater Expectations Panel, a group developed by AAC&U to define the aims of a 21st century undergraduate education and to identify strategies for accomplishing these aims. Dr. Ramaley's model of developing and supporting leadership throughout the university is considered a hallmark of her tenure, as well as her charge to seek out and cultivate partnerships with both businesses and cultural entities across the state.

(continued on next page)

Room: Big Ten A/B

Julie E. Williams

Senior Vice Provost for Engagement and Academic Outreach
University of New Hampshire

Julie Williams, Ph.D., is senior vice provost for engagement and academic outreach at the University of New Hampshire. She established the University's first Office of Engagement and Academic Outreach and is responsible for the development of funded research and education initiatives and grants to advance the work of individual faculty and multidisciplinary faculty teams that collaborate with external partners. Dr. Williams also provides leadership for two semester-long faculty development academies and four faculty learning communities. Since joining UNH in 2001, she has held key leadership roles in strategic planning and review, institutional accreditation, and communications planning. Dr. Williams chaired the planning team that resulted in the university's "Community Engagement" classification by the Carnegie Foundation for the Advancement of Teaching. She developed the institution's first long-term, federally funded partnership with a historically black university, which has garnered national recognition. Dr. Williams also led the statewide planning effort in partnership with New Hampshire's Office of Economic Stimulus to help focus opportunities for the state of New Hampshire on the American Recovery and Reinvestment Act. She has served on the national advisory board for the "Engagement Academy for University Leaders," and has been a faculty member for the Emerging Engagement Scholars Workshop. She developed the Engaged Scholarship Writing Team which is currently working on a series of articles focused on the UNH model of engaged scholarship, to be published as a special journal issue. Prior to joining UNH, she held administrative and faculty appointments at Virginia Commonwealth University, the University of Tennessee, the University of Tennessee Medical Center, and Knoxville College.

Jeri L. Childers

Fellow, Virginia Tech Center for Organizational and Technological Advancement
Virginia Tech University

Jeri Childers, Ph.D., conducts research, publishes, presents, and practices in engaging university and community leaders for civic change. Dr. Childers created the Engagement Academy for University Leaders, which has been offered by Virginia Tech's Center for Organizational and Technological Advancement since June, 2008. The program has won awards for its innovation and quality and has fostered a growing portfolio of related programs. Dr. Childers is collaborating with the Association of Public Land-grant Universities, the Coalition of Urban Metropolitan Universities, the American Association of State College Universities, the Community-Campus Partnerships for Health, and the Transformational Regional Networks to offer these programs and to share resources for post-secondary institutions, engaged scholars, and civic leaders. Currently, she is also supporting the development of the TRE Networks and the Transformation Regional Engagement Toolkit, which offers tools and models for campus-community partnerships for regional economic, community, and workforce development. Dr. Childers serves on the editorial board of the *Journal for Higher Education Outreach and Engagement*. Prior to working at Virginia Tech, Dr. Childers served at Penn State and was the founding chair of the National Outreach Scholarship Conference.



This session is sponsored by the
Engagement Academy for University Leaders
at Virginia Tech University.

Concurrent Session 3**Symposium 8: Preparing and Supporting Engaged Scholars**

Room: 105

Critical Reflections: Evolution and Outcomes of Graduate Certification in Engagement

Diane M. Doberneck, Michigan State University; **Robert E. Brown**, Michigan State University; **Laurie Van Egeren**, Michigan State University; **Jessica Barnes**, Michigan State University; **Miles McNall**, Michigan State University

Practicing What We Preach: Examining the Emerging Engagement Scholars Program

Kate Guerdat, North Carolina State University; **John B. Cook**, Granite State College

Birthing and Growing A Campus-wide Engaged Scholarship Umbrella Organization

Heather Pleasants, University of Alabama; **Jackie Brodsky**, University of Alabama; **Tiarney Ritchwood**, University of Alabama; **Maryann S. Whitaker**, University of Alabama; **Joshua White**, University of Alabama

(continued on next page)

From Grad to Gray: Engagement Across the Faculty Career Span

Shannon Wilder, University of Alabama; **Paul Matthews**, University of Georgia;
Trish Kalivoda, University of Georgia; **David Knauff**, University of Georgia

Symposium 9: Perspectives on Community-Based Research

Room: 104

Community and Academic Members' Perspectives on a CBPR Environmental Partnership

Rosemary Valedes Chaudry, Ohio State University; **Susan Colbert**, Ohio State University;
Evelyn Van Til, Community Advocate

Expanding the Scope of Participatory Action Research: Include Community Context

Mariah E. Kornbluh, Michigan State University; **Pennie Foster-Fishman**, Michigan State University;
Erin Watson, Michigan State University

Participatory Community-Driven Research: Building Relationships, Earning Respect and Exercising Indigenuity

Daniel Wildcat, Haskell Indian Nations University; **Venida Chenault**, Haskell Indian Nations University;
Smokey McKinney, Haskell Indian Nations University;
Lorene Williams; **Bill Welton**; **Julia Goodfox**

Workshop 10: Exploring the Construct 'Service' as it Relates to Engaged Scholarship

Room: 101

Antoinette R. Smith-Tolken, Stellenbosch University; **Jacob M. J. du Plessis**, Stellenbosch University

Workshop 11: Reaching Out to Promote Campus Diversity in the 21st Century

Room: 62 (on lower level)

William Collins, University of Michigan; **Mary Beth Damm**, University of Michigan;
Laura Roop, University of Michigan

Workshop 12: University of New Hampshire's Model of Engaged Scholarship: Defining a 21st Century Community-Engaged Research University

Room: 103

Julie Williams, University of New Hampshire; **Eleanor Abrams**, University of New Hampshire;
Lisa Townson, University of New Hampshire; **Lorilee Sandmann**, University of Georgia; **Charlie French**,
University of New Hampshire; **Mihaela Sabin**, University of New Hampshire – Manchester; **Wendy Lull**,
Seacoast Science Center; **Scott Jones**, University of New Hampshire; **Trish Kalivoda**, University of Georgia

Workshop 13: CIM: Technology as a Tool to Engage and Empower Organizations

Room: Heritage

Mary Simon Leuci, University of Missouri-Columbia; **Beth Kerrigan**, Bell South;
Jeff Hayward, United Way

Workshop 14: Doing Community-Based Participatory Research (CBPR) with Emplaced Rigor

Room: 106

Sherry Ann Chapman, University of Alberta; **Bethan Kingsley**, University of Alberta

Poster Symposium 3: Engaging the Armed Forces

Room: Michigamme (on lower level)

Promoting Sustainability Among Evidence-based Programs and Practices

Daniel Perkins, Pennsylvania State University

Identifying Evidence-based Programs and Practices

Daniel Perkins, Pennsylvania State University

University Engagement with the Military Community: Serving Those Who Serve

Casey Mull, University of Georgia

Military Engagement and Outreach Scholars Academy: Assuring Excellence in Practice

Beth Velde, East Carolina University

Concurrent Session 4

Symposium 10: International Student Engagement

Room: 106

International Service-Learning: Evidence of Student Personal and Professional Growth

Linda Knecht, University of Michigan - Flint; **Maureen Tippen**, University of Michigan - Flint

Preparing Graduate Students as Engaged Scholars Through International Collaborative Work

Ann Austin, Michigan State University; **Alex Akulli**, Michigan State University;
Chris Glass, Michigan State University; **Pam Roy**, Michigan State University

Generating Transdisciplinary Knowledge via Service-Learning Study Abroad

Daphene Koch, Purdue University; **Paul Ebner**, Purdue University;
Sandra Sydnor-Bouso, Purdue University; **Lori U. Snyder**, Purdue University

Symposium 11: Health and Health Care Engagement

Room: 104

Improving Urban Health Through Community-Based Research and Engaged Pedagogies

Gail Heffner, Calvin College; **Sergio da Silva**, Calvin College; **David Warners**, Calvin College;
Gail Zandee, Calvin College

International Family Practice Training Program in China

Guozhen Liu, Genesys Regional Medical Center; **Randolph L. Pearson**, Michigan State University

Health Needs of Women in Nepal

Murari Suvedi, Michigan State University

University-Public School Partnership to Enhance Rural Mental Health Services

Jeannie Golden, East Carolina University

Symposium 12: Positive Youth Development

Room: 103

Future You: Reaching Middle School Students and their Families

Michael Turner, University of Michigan

Promoting the Academic Success of Young Boys of Color

Gabriela Saenz, Michigan State University; **Patricia Farrell**, Michigan State University; **Marvin McKinney**, Michigan State University

Holistic Community Change: Developmental Assets and Positive Youth Outcomes

Carl Kallgren, Penn State Erie - The Behrend College; **Tammy Bartasavich**, Penn State Erie - The Behrend College; **Abigail L. Biebel**, Penn State Erie - The Behrend College; **Cathleen L. Smith**, Union City School District; **Judy R. Gawlinski**, Union City High School; **Alisa Wiley**, Union City Area School District

Workshop 15: Building Evaluation Capacity by Engaging Community in a Practice-based Course

Room: Riverside (on lower level)

Lori Bakken, University of Wisconsin - Madison; **Cathy Couture**, Orion Family Services; **Jennifer L. Danielewicz**, University of Wisconsin - Madison

Workshop 16: Student and Community Voices: Interview Theatre as Outreach and Engagement

Room: Heritage

Susan Harden, University of North Carolina - Charlotte; **Robin Witt**, University of North Carolina

Workshop 17: Engaging All Voices: Participatory Design Methods in Design/Build Outreach Studios

Room: 101

Susan Melsop, Ohio State University; **Jackie Calderone**, Central Community House; **Andrew Calhoun**, Ohio State University

(continued on next page)

11:15 a.m. – 12:30 p.m.

Concurrent Session 4 (continued)
Workshop 18: Engagement of Low-Income Families: Retention and Communication Approaches

Room: 62 (on lower level)

Holly Stack-Cutler, University of Alberta; **Laurie Schnirer**, University of Alberta

Workshop 19: 2011 NOSC Journal Editors' Panel

Room: 105

Patricia L. Kalivoda, *Journal of Higher Education Outreach and Engagement*
Cassandra E. Simon, *Journal of Community Engagement and Scholarship*
Catherine Paterson, *Journal of Community Engagement and Higher Education*
R. Dale Safrit, *International Journal of Volunteer Administration*
David Van Zytveld, *Gateways: International Journal of Community Research and Engagement*
Michelle S. Rodgers, *Journal of Extension*

This session will be convened by:

Hiram E. Fitzgerald, *Infant Mental Health Journal*
**MICHIGAN STATE
UNIVERSITY**

University Outreach
and Engagement
National Collaborative for the
Study of University Engagement

Workshop 19 is also a part of the Emerging Engagement Scholars Workshop and is sponsored by the National Collaborative for the Study of University Engagement at Michigan State University.

12:30 p.m. – 1:15 p.m.

Lunch

Room: Big Ten A/B

1:15 p.m. – 2:30 p.m.

Plenary Session 4: Technologies as Tools for Engagement

Room: Big Ten A/B

What role can digital technologies play in the ways in which communities and citizens think and act together? What are the possibilities of a “civic intelligence” that organizes, mobilizes, and improves shared thinking and action in the face of shared challenges? How can the use of technologies facilitate shared thinking and problem-solving? Two noted speakers, each of whom has spent considerable time working with communities and developing digital tools, will share their thoughts. The session will provide an opportunity for thoughtful and critical discussion of the implications of these themes for work with communities.

Convener:
Jeffrey T. Grabill

Professor, Department of Writing, Rhetoric, and American Cultures
Co-Director, Writing in Digital Environment (WIDE) Research Center
Michigan State University

Jeffrey T. Grabill, Ph.D., is professor of Rhetoric and Professional Writing and co-director of the WIDE Research Center at Michigan State University. He is interested in how people write together to do the knowledge work of their everyday lives. Dr. Grabill's research is located at the intersection of professional and technical writing, rhetorical theory, and literacy theory, and focuses on the literate and technological practices of citizens, users, students, and others within communities and non-academic institutions. He is the author of two books, *Writing Community Change: Designing Technologies for Citizen Action* (Hampton, 2007) and *Community Literacy Programs and the Politics of Change* (SUNY, 2001), and has published articles in such journals as *College Composition and Communication*, *Technical Communication Quarterly*, *Computers and Composition*, and *English Education*. Prior to his work at MSU, he taught composition, technical writing, and digital rhetoric courses at Georgia State University.

Presenters:
Douglas Schuler

Member of the Faculty
Evergreen State College

Douglas Schuler's work focuses on the opportunities and risks of information and communication systems in the social realm, and democratic, equitable, and sustainable uses of technology. Mr. Schuler is the director of the Public Sphere Project, where he is working on projects such as e-Liberate, a web-based application that supports distributed meetings using Robert's Rules of Order. He explores the idea of “civic intelligence,” the collective capability of society to address its problems, with his teaching, learning, and organizing. He is author of *Liberating Voices: A Pattern Language for Communication Revolution* (MIT Press, 2008); coeditor of several books, including *Shaping the Network Society: The New Role of Civic Society in Cyberspace* (MIT Press, 2004); author of *New Community Networks: Wired for Change* (ACM Press, 1996); and has written numerous articles and book chapters. Mr. Schuler is the former chair of Computer Professionals for Social Responsibility (CPSR), a public-interest organization concerned about the impact of computers on society. He also co-founded the Seattle Community Network (SCN), an all-volunteer, free public access computer network.

(continued on next page)

1:15 p.m. – 2:30 p.m.

Plenary Session 4 (continued)

Room: Big Ten A/B

Alan Webb

Partner

Night Train Consulting

Alan Webb is the project manager of Community Weaver 2.0 and one of two directors of the minimalist systems engineering partnership Night Train Consulting. He specializes in helping organizations rethink the use of technology to create more and better human interactions offline. Mr. Webb leads the Peer to Peer University (P2PU) School of Social Innovation and efforts to spread the Citizen Circles methodology, a simple and powerful way for small groups to improve themselves and the world around them through a learning process they create for themselves. He also works with TimeBanks, a Washington, D.C.-based organization that promotes equality and caring community economies. His past work has included: starting a self-sustaining student-run course evaluations forum at the University of Virginia; working in corporate sustainability strategy for the founder of the Australian Green Building Council and the head of sustainability for one of Australia's largest multinational property companies; helping organize the first-ever Tibetan Social Business Conference in Tibet; and teaching social entrepreneurship to Tibetan youth in Tibet.

2:30 p.m. – 3:00 p.m.

Break • Room: Centennial A/B/C

3:00 p.m. – 4:15 p.m.

Concurrent Session 5

Symposium 13: Centrality of Engagement in Higher Education

Room: 105

Convening Constructive Conversations about Engaged Scholarship in Promotion and Tenure

Diane M. Doberneck, Michigan State University; **Chris R. Glass**, Michigan State University

Assessing Impacts of Engagement Practices: Factors of Scale

Susan Erickson, Iowa State University; **Timothy O. Borich**, Iowa State University

Is the Civic Engagement Movement Changing Higher Education?

John Saltmarsh, New England Resource Center for Higher Education;

Matthew Hartley, University of Pennsylvania

Assessing Outreach and Engagement: Applying the Principles of Institutional Effectiveness

Valerie Paton, Texas Tech University; **Birgit L. Green**, Texas Tech University

Symposium 14: Translational Science and Health

Room: 104

Health Communication Campaigns as Engaged Pedagogy

Emily Haas, Purdue University; **Carin L. Kosmoski**, National Institute for Occupational Safety and Health (NIOSH) Office of Mine Safety and Health; **Stephanie L. Orstad**, Purdue University

New STEPS to Breast Health: Community-Based Research in Appalachia

Eugene Lengerich, Pennsylvania State University; **Marcy A. Bencivenga**, Pennsylvania State University; **Nancy R. Wiker**, Pennsylvania State University; **Michelle A. Farnan**, Pennsylvania State University; **Andrea Bressler**, Pennsylvania State University

Using Pedigree Space to Expand a Community-based Translational Genetics Project

Joseph Bonner, Michigan State University

Symposium 15: Talent and Workforce Development

Room: 103

Workforce Skills of High School Graduates

Greg Homan, Wright State University, Lake Campus; **Jason Hedrick**, Ohio State University; **Jeff Dick**, Ohio State University; **Mark Light**, Ohio State University

Developing and Deploying a Workforce Development Program for Sustained Growth

Julia Storberg-Walker, North Carolina State University; **Dave Boulay**, Illinois Manufacturing Extension Center; **Diane Chapman**, North Carolina State University

Ameliorating Intergenerational Poverty: Educational Attainment, Social Capital, and Workforce Development

Dane Partridge, University of Southern Indiana; **Sudesh Mujumdar**, University of Southern Indiana

(continued on next page)

Workshop 20: Definitions of and Approaches to Public Engagement: A Language-in-Use Analysis

Room: 106

James Woodell, Pennsylvania State University; **Ezekiel W. Kimball**, Pennsylvania State University**Workshop 21: Multi-Level, Mixed-Method Impact Evaluation of a Statewide Workforce Development Program**

Room: 101

Michael Polzin, Michigan State University; **John P. Beck**, Michigan State University; **Julie L. Brockman**, Michigan State University; **Donna Winthrop**, Michigan State University; **Christine Quinn**, South Central Michigan Works!; **Jim Lautenschlager**, South Central Michigan Works!**Workshop 22: Sharing our Stories of Community Engagement**

Room: Heritage

Beth Velde, East Carolina University**Workshop 23: Designing a Community Identity for SW Raleigh through Engaged Scholarship**

Room: Riverside (on lower level)

Traci Rose Rider, North Carolina State University;**Celen Pasalar**, North Carolina State University**Workshop 24: The Role of Digital Communication in Advancing Engagement**

Room: 62 (on lower level)

Sarah Swierenga, Michigan State University; **Constantinos K. Coursaris**, Michigan State University; **Ghada Georgis**, Michigan State University; **Michael S. Elledge**, Michigan State University**Poster Symposium 4: Tribal Head Start: Building Culturally Appropriate Early Childhood Education Systems**

Room: Michigamme (on lower level)

Maternal Smoking is Related to Teacher's Perceptions of Head Start Children's Externalizing and Internalizing Behavior Problems**Hiram E. Fitzgerald**, Michigan State University; **KyungSook Lee**, Michigan State University; **Jessica V. Barnes**, Michigan State University; **Patricia Farrell**, Michigan State University; **Ann Belleau**, Inter-Tribal Council of Michigan; **Hope K. Gerde**, Michigan State University**Methodological Engagement - Using Photovoice to Empower American Indian Communities****Nicole L. Thompson**, University of Memphis**Effects of Distance Learning Professional Development for Teachers on American Indian Head Start Children's Math and Literacy Outcomes****Hope K. Gerde**, Michigan State University; **Jessica V. Barnes**, Michigan State University; **Ann Belleau**, Inter-Tribal Council of Michigan; **Heather A. Whitty**, Michigan State University; **Hiram E. Fitzgerald**, Michigan State University**The Relations of Quality of Family Environment and Parenting Belief to Young Children's Socioemotional Functioning****Patricia Farrell**, Michigan State University; **KyungSook Lee**, Michigan State University; **Jessica V. Barnes**, Michigan State University; **Hope K. Gerde**, Michigan State University; **Hiram E. Fitzgerald**, Michigan State University; **Ann Belleau**, Inter-Tribal Council of Michigan**Growth in Children's Language, Cognitive, and Social Skills across One Year of American Indian Head Start****Jessica V. Barnes**, Michigan State University; **Hope K. Gerde**, Michigan State University; **Hiram E. Fitzgerald**, Michigan State University; **Patricia Farrell**, Michigan State University; **Mary Calcaterra**, Michigan State University; **Arnie Parish****Parent and Teacher Ratings of Children's Adaptive Behavior****Patricia Farrell**, Michigan State University; **Hiram E. Fitzgerald**, Michigan State University; **Jessica V. Barnes**, Michigan State University; **Hope K. Gerde**, Michigan State University; **Ann Belleau**, Inter-Tribal Council of Michigan; **KyungSook Lee**, Michigan State University**Improving Children's Academic Readiness through High Quality Tribal Head Start Programs****Jessica V. Barnes**, Michigan State University; **Hope K. Gerde**, Michigan State University; **Ann Belleau**, Inter-Tribal Council of Michigan; **Patricia Farrell**, Michigan State University; **KyungSook Lee**, Michigan State University; **Hiram E. Fitzgerald**, Michigan State University

Poster Session 2 with Reception

A full list of the posters that will be on display during this session is available on page 35

Annual NOSC Institutional Members Meeting with Reception

Room: MSU Museum

Session Notes

Plenary and Concurrent Sessions
Monday, October 3

Tuesday, October 4

7:00 a.m. – 12:30 p.m.

Registration

7:30 a.m. – 8:00 a.m.

Continental Breakfast

Room: Centennial A/B/C

8:00 a.m. – 9:15 a.m.

Plenary Session 5: Globalization and International Engagement

Room: Big Ten A/B

In this session, two scholars who have developed successful and long-standing partnerships with institutions and groups abroad will discuss their experiences and offer insights into building and sustaining effective international partnerships. Themes include: how to build trust, mutual understanding, and genuinely reciprocal relationships with partners in other countries; means of developing multi-disciplinary and multi-institutional collaborations; sustaining international partnerships over periods of time; and roles of government agencies and NGOs. The session will be informative and suggestive of new ways to think about university-community partnerships and community-engaged scholarship in a global context.

Convener:**Frank A. Fear**

Senior Associate Dean, Agriculture and Natural Resources
Michigan State University

Frank Fear, Ph.D., is senior associate dean, College of Agriculture and Natural Resources, Michigan State University. He studies, writes, and teaches about forms of extraordinary change in organizational and community settings with a focus on change resulting from collaboration with higher education. His articles have appeared recently in the *Journal of Leadership Studies*, *Innovative Higher Education*, *Metropolitan Universities*, the *Journal of College and Character*, *About Campus*, and *Encounter*. He is a frequent contributor to the *Journal of Higher Education Outreach and Engagement* and was lead author of *Coming to Critical Engagement: An Autoethnographic Exploration* (University Press of America, 2006). He was the inaugural chairperson of the Liberty Hyde Bailey Scholars Program, a distinctive undergraduate program that promotes undergraduate student and faculty development through collaborative learning, where he continues to teach undergraduate and graduate courses, and design new courses. He also previously served as: acting associate director of MSU Extension; chairperson of the MSU Department of Resource Development; president and CEO of the Greater Lansing Food Bank; and was a founding member of the Capital Area Food Security Coalition. As well, Dr. Fear has been a consulting scholar with the W. K. Kellogg Foundation, most recently in conjunction with the Food Systems Higher Education-Community Partnership initiative.

Presenters:**Gretchen L. Birbeck**

Professor, Neurology and Epidemiology
Director, MSU International Neurological and Psychiatric Epidemiology Program
Michigan State University

Gretchen Birbeck, M.D., M.P.H., D.T.M.H., F.A.A.N., became interested in neuroepidemiology and health services research while working in sub-Saharan Africa in the early 1990s. As a neurologist, she has investigated the neurologic conditions presenting to a large rural Zambian hospital. Epilepsy and other seizure disorders constitute a major health problem in this region and ongoing investigations via population-based surveys and case-control studies are being conducted to determine the prevalence of epilepsy in the region and to explore why epilepsy is so common. Her health services research has focused upon epilepsy care and care for vulnerable populations. She is particularly interested in non-traditional outcome measures, including health-related quality of life measures in epilepsy care assessment. She is also principal investigator for the California Resources in Stroke Study, a population-based study of hospital-based stroke care in California.

8:00 a.m. – 9:15 a.m.

Plenary Session 5: (continued)

Room: Big Ten A/B

Peter S. Spencer

Professor, Neurology
Director, OHSU Global Health Center
Oregon Health and Science University

Peter Spencer, Ph.D., FRCPATH, received his doctoral degree from the University of London, Faculty of Medicine (Pathology), and postdoctoral training in neuroscience in the Rose F. Kennedy Center for Research on Mental Retardation and Human Development of the Albert Einstein College (AECM) of Medicine. One of five national Joseph P. Kennedy, Jr., fellows in the Neurosciences (1974-76), he became professor of neuroscience, neurology and pathology at AECM, and founding director of the Institute of Neurotoxicology. In 1988, he joined Oregon Health & Science University (OHSU) to found the Center for Research on Occupational and Environmental Toxicology, which he directed for 21 years. In 2007, Dr. Spencer founded and led the OHSU Global Health Center. He has served as principal investigator on numerous federal, individual, program, project, and center grants, including a current Framework for Global Health program grant. Dr. Spencer holds six honorary professorial appointments at foreign institutions, including several in China. An emeritus member of the American Society of Toxicology (2011), he was also 2010 keynote lecturer for the Society of Toxicologic Pathology and the International Federation of Societies of Toxicologic Pathologists. He is an honorary member of the Indian Academy of Neurosciences (2005) and recipient of numerous awards.

9:30 a.m. – 10:45 a.m.

Concurrent Session 6

Symposium 16: Perspectives on Community Engagement: Four National Contexts

Room: 105

Emergent Forms of Engaged Scholarship at a South African University

Bernadette Judith Johnson, Vaal University of Technology; **David Cooper**, University of Capetown

Early Engagement: Measuring an Outreach Program's Impact

Danni Jansen, University of Queensland; **Michael Cuthill**, University of Queensland

Engaged in Costa Rica: Action- and Service-Learning Abroad

Leigh Askew Elkins, University of Georgia; **Danny H. Bivins**, University of Georgia

Building Equity in Global Partnerships: Buffalo - Tanzania Education Project

Mara Huber, University at Buffalo; **Katie J. Biggie**, University at Buffalo;
Godfrey Telli, University at Buffalo

Symposium 17: Citizen Engagement and Outreach Strategies for Emerging Technologies

Room: 103

Citizen Engagement and Outreach Strategies for Emerging Technologies

John Stone, Michigan State University; **Kyle Powys Whyte**, Michigan State University;
Pat J. Gehrke, University of South Carolina; **Weston M. Eaton**, Michigan State University;
Stephen Philip Gasteyer, Michigan State University; **Wynne Wright**, Michigan State University

Workshop 25: Tips for Preparing a 2012 Outreach Scholarship Kellogg Award Application

Room: 104

Patricia Kalivoda, The University of Georgia; **James J. Zuiches**, North Carolina State University;
John V. Byrne, Oregon State University

Workshop 26: Creative Academic Outreach Activities: The University of Tennessee Showcase

Room: 106

Jeffrey D. Kovac, University of Tennessee – Knoxville; **Thomas K. Davis**, University of Tennessee – Knoxville

Workshop 27: Bridging Scholarship, Heart, and Service-Learning: The International, Translational Case

Room: 62 (on lower level)

Sandra Sydnor-Bousso, Purdue University; **Mope Adeola**, Purdue University;
Thelma Snuggs, Purdue University

Workshop 28: Scholarly Engagement for Online Learning

Room: 101

Lisa Hebgren, University of Wisconsin – Madison; **Mark Dziedzic**, University of Wisconsin – Madison

Workshop 29: A Unified Front for University Pre-College Programs

Room: Red Cedar B

Zach Constan, Michigan State University; **Judy Ratkos**, Michigan State University; **Leonard A. Savala**, Michigan State University

Workshop 30: Agroecology and Participatory Modeling to Build Resilience among Smallholder Communities

Room: Heritage

Sieglinde Snapp, Michigan State University; **Laura Schmitt Olabisi**, Michigan State University

(continued on next page)

9:30 a.m. – 10:45 a.m.

Concurrent Session 6 *(continued)*
Poster Symposium 5: Creative Methods and Community Change

Room: Michigamme (on lower level)

Building Teams of Leaders in Healthcare: Collaborating for Success

Candace Gibson, University of Western Ontario; **Jessica J. Gardon Rose**, Central Michigan University;
Dag von Lubitz, Central Michigan University;
Steven D. Berkshire, Central Michigan University

Mapping Cultural Legacy, The South Park-East Raleigh Historic District
Kermit Bailey, North Carolina State University

Translating University Knowledge to the General Public at Art/Science/Engagement Interface

Paula Miller, Michigan State University; **Diane M. Doberneck**, Michigan State University; **John H. Schweitzer**, Michigan State University

Measurement Moments: Embedding Research into Informal Education at Art/Science/Engagement Interface

Diane M. Doberneck, Michigan State University; **Paula Miller**, Michigan State University; **John H. Schweitzer**, Michigan State University

Participatory Action Research from a Distance

Pennie Foster-Fishman, Michigan State University; **Lauren F. Litchy**, Michigan State University; **Jenny Mortensen**, Michigan State University; **Mariah E. Kornbluh**, Michigan State University

One Kalamazoo, One Community: A Multidisciplinary University-Community Partnership

Timothy Ready, Western Michigan University; **Donald Cooney**, Western Michigan University; **Richard Cooper**, Western Michigan University;
Caroline Webber, Western Michigan University

Restorative Justice: Change the Paradigm, Change the World
Nancy Schertzing, Michigan State University

10:45 a.m. – 11:15 a.m.

Break • Room: Centennial A/B/C

11:15 a.m. – 12:30 p.m.

Concurrent Session 7
Symposium 18: Science and Technology Education

Room: 105

Towards Determining the Extent of Engaged Scholarship for SET

Patricia Gouws, University of South Africa; **Jan C. Mentz**, University of South Africa

Translating Complex Science to Many Audiences

Robin Tinghitella, Michigan State University; **Lynn Sametz**, University of North Carolina - Greensboro;
Dickson Wambua, University of North Carolina - Greensboro

IW2K! (I Want to Know!) - Motivating Youth in Science, Engineering, and Technology
Joanna M. Skluzacek, University of Wisconsin – Extension

Science Education Assistants for Elementary Schools in Japan

Nozomi Hotta, Ochanomizu University; **Koji Miyamoto**, Ochanomizu University;
Kazuoyoshi Chiba, Ochanomizu University

Symposium 19: eXtension

Room: 103

Grantsmanship for Online Equine Education: Leveraging Innovative Tools and Partnerships

Karen Waite, Michigan State University; **Elizabeth Greene**, University of Vermont;
Christine Skelly, Michigan State University; **Jennifer Whittle**, University of Kentucky;
Gwyn Heyboer, Michigan State University

MyHorseUniversity and eXtension HorseQuest: A Successful Model for Educational Partnerships

Christine Skelly, Michigan State University; **Elizabeth Greene**, University of Vermont;
Karen Waite, Michigan State University

Keeping Expert Contributors and the Audience Engaged Over Time
Elizabeth Greene, University of Vermont

If You Build It, Will They Come? Promoting eXtension Locally
Elizabeth Greene, University of Vermont; **Michael Lambur**, Virginia Tech

(continued on next page)

Symposium 20: Community Engaged Research with Latino Communities

Room: 104

Nutrition and Physical Activity in a Summer Migrant Classroom

Jill F. Kilanowski, Case Western Reserve University

It is More than Speaking Spanish: Community-Based Research with Hispanics

Rubén Martinez, Michigan State University; Pilar Horner, Michigan State University; Celina Wille, Michigan State University

Workshop 31: A Comprehensive Trails Project: Developing and Maintaining Partnerships

Room: Riverside (on lower level)

Anne Statham, University of Southern Indiana

Workshop 32: ABLe Framework: Conceptual and Methodological Tools for Promoting Systems Change

Room: 101

Pennie Foster-Fishman, Michigan State University; Erin Watson, Michigan State University

Workshop 33: IUPUI Solution Center: An Innovative Model for University-Community Engagement

Room: Red Cedar B

Christine Fitzpatrick, Indiana University – Purdue University Indianapolis;

Sarah Tansy Zike, Indiana University – Purdue University Indianapolis

Workshop 34: Where's Waldo? Finding and Communicating Outreach Using Innovative Website Technologies

Room: 62 (on lower level)

Jeanne McDonald, University of Colorado - Boulder; Linda Molner Kelley, University of Colorado - Boulder

Workshop 35: Building Institutional Capacity for Community Engagement: Lessons Learned

Room: 106

Jeri Childers, Virginia Tech; Lorilee R. Sandmann, University of Georgia; James M. Dubinsky, Virginia Tech

Workshop 36: St. Thomas University/Port-de-Paix, Haiti, Global Solidarity Partnership

Room: Heritage

Anthony Vinciguerra, St. Thomas University

Poster Symposium 6: International Engagement at Home and Abroad

Room: Michigamme (on lower level)

Community Engagement Abroad Increases Extension Educators' Local Cross-Cultural Competencies

Celina Wille, Michigan State University; Larry G. Olsen, Michigan State University;

Gretchen L. Hoffing, Michigan State University; Dixie Sandborn, Michigan State University

Mapping: A Strategic Tool for NGO Asset Evaluation and Planning

Bradley Doudican, Ohio State University

Engaging through International Psychology, the Bridge to Global H.O.P.E.

Tiffany Masson, Chicago School of Professional Psychology;

Erica Rumpel, Chicago School of Professional Psychology

From Detention Camps to North Carolina: One Hmong Family's Story

Tracy Carpenter-Aeby, East Carolina University; Victor G. Aeby, East Carolina University;

Victoria C. Aeby, East Carolina University; Shauna K. Daniels, NOVA Behavioral Health Care

International Embedded Field-Courses: Emulating Professional Science Practice while Embracing Conservation

Jacqueline McLaughlin, Pennsylvania State University - Lehigh Valley; Kathleen Fadigan,

Pennsylvania State University - Abington; Darin S. Munsell, Illinois Institute of Technology

Poster Awards, Closing Remarks and 2012 Invitation*(with boxed lunch)*

Room: Big Ten A/B

NOSC Implementation Committee Debriefing*(by invitation only)*

Room: Red Cedar B

Poster Presentations

Two distinct poster sessions are scheduled, each with a different lineup of posters. Poster sessions feature a reception with light food and drinks. The most outstanding posters of 2011 will also be recognized, as determined by a panel of judges, with special awards presented on the last day of the conference.

Poster sessions are located at: Big Ten C

Sunday, October 2, 4:30 – 6:30 p.m.

Monday, October 3, 4:15 – 6:15 p.m.



Poster Session 1

Sunday, October 2

4:30 p.m. - 6:30 p.m.

Room: Big Ten C

Cultural Preservation

U.S./Africa Cultural Heritage Strategic Collaborations in a Digital Age

C. Kurt Dewhurst, Michigan State University; Marsha L. MacDowell, Michigan State University; James Pritchett, Michigan State University; Dean A. Rehberger, Michigan State University

Our Daily Work/Our Daily Lives: Preserving and Presenting Workers Culture

John P. Beck, Michigan State University; Yvonne R. Lockwood, Michigan State University

Master Folk Artists as Community Scholars and Mentors

LuAnne Kozma, Michigan State University

Creating Race Knowledge: The Maggie Walker/St. Luke Research Community

Monica Griffin, College of William and Mary

Distance Learning

An Internet-based Program to Disseminate Training in Evidence-based Autism Intervention

Allison Wainer, Michigan State University; Brooke R. Ingersoll, Michigan State University

Proposing Open Courseware Module Development with International Partners

Dave King, Oregon State University

Video Presence in Academia: Moving Far Beyond Campus Boundaries

Maris Stella Swift, Grand Valley State University; Laurie Anne Witucki, Grand Valley State University; Linda A. Masselink, Grand Valley State University; Anne M. Merkle, Grand Valley State University

A Community-Based Intervention by an Open Distance Learning Institution

Pfunzo Sidogi, University of South Africa

Impactful Formative Evaluation Practices in Community-Based Online Learning Projects

Scott Schaffer, Purdue University

Faculty Development

Beyond Good Intentions: Rethinking Curriculum Delivery

Alejandra Gudino, University of Missouri; Kim Allen, North Carolina State University

Improving the Writing, Editing, and Readability of Community Engagement Journals

Cassandra Simon, University of Alabama; Edward Mullins, University of Alabama; Heather Pleasants, University of Alabama; Jessica Averitt Taylor, University of Alabama; Marion Walding, University of Alabama

Day on the Bus: Introducing Faculty/Staff to the Regional Community

Elissa Bakke, University of Southern Indiana; Matthew Hanka, University of Southern Indiana; Richard A. Coleman, Vincennes University

Teaching Community-Based Research to Undergraduates

Howard Rosing, DePaul University

Challenges and Alternatives to Promote Evidence-Based Outreach Engagement

Koralalage Jayaratne, North Carolina State University; Patricia Sobrero, North Carolina State University

A Framework to Build Cultural Competency for Outreach Program Evaluation

Koralalage Jayaratne, North Carolina State University; Patricia Sobrero, North Carolina State University

Assessing Faculty Fellows Programs for Service-Learning Professional Development

Paul Matthews, University of Georgia; Shannon O. Wilder, University of Georgia; Stacey Kolomer, University of Georgia

Cultivating Curricular Change through Service-Learning: Lessons Learned through Dissemination

William Oakes, Purdue University

Institutional Research, Models, and Leadership

Being Relevant, Being Responsive: Reciprocal Learning between Universities and Communities

Catherine Schenck, University of South Africa; Elaine Sonet Harrison, University of South Africa

Social Responsibility: Core Value and Practice

Cynthia Struthers, Western Illinois University; Christopher D. Merrett, Western Illinois University

The University in Development: Theoretical perspectives on Engaged Scholarship in South Africa

David Cooper, University of Cape Town

Building a Service-Learning Curriculum at the University of Connecticut

David Williams, University of Connecticut – Greater Hartford Campus

The Community-University Exchange: Building an infrastructure for Meaningful Partnerships

Elizabeth Tryon, University of Wisconsin – Madison; Margaret Nellis, University of Wisconsin – Madison; J. Ashleigh Ross, University of Wisconsin – Madison; Ariel Kaufman, University of Wisconsin – Madison

Community Engagement Practices, Costs, and Benefits

Marcie Simpson, University of Georgia

Institutionalizing Service-Learning in Higher Education: Ten Key Organizational Factors

Neivin Shalabi, University of Denver

Practicing What We Preach: Using Evidence-Based Inquiry in Assessment

Patrick Lucas, University of North Carolina – Greensboro

Community Campus Partnerships for Mutual Capacity Building

Sue Levesque, York University; Lesley Elizabeth Beagrie, York University; Michaela Hynie, York University; Yvette M. Munro, York University; Brenda Spotton Visano, York University

Research Methods and Practices

Using Participatory Action Research as a Program for Black Girls

Adrienne Duke, University of Wisconsin – Madison

Visual Strategies: Activity-Based Focus Groups in CBPR

Alicia Hibbert, University of Alberta; Fay Fletcher, University of Alberta; Lola Baydala, University of Alberta; Fiona Robertson, University of Alberta

Making the Team: Conducting Hierarchical Interdisciplinary Community Service Learning Research

Christine Yalda, Grand Valley State University; Carly Hilinski, Grand Valley State University

Community Based Systemic Change at an Urban Land Grant College

Eric Dunker, University of Denver

Measuring Academic Capacity: Research in Relationship

Fay Fletcher, University of Alberta; Lola Baydala, University of Alberta; Stephanie Worrell, University of Alberta; Barbara McLean, University of Alberta; Davina Rousell, University of Alberta

Project Tuscaloosa: Development of a Partnership Model for Community Engagement

Jessica Taylor, University of Alabama; D. Scott Batey, University of Alabama; James E. Taylor, University of Alabama; Heidi Helmer, University of Alabama; Cassandra E. Simon, University of Alabama

Engaging Research and Extension to Support Northeast Organic Dairy Industry

Lisa Townson, University of New Hampshire; David H. Townson, University of New Hampshire

Student Outcomes

College Unbound: A New Model for Undergraduate Outreach and Scholarship

Dennis Littky, College Unbound; Adam Bush, College Unbound

Assessment of Student Participation in an International Pharmacy Practice Experience

Ellen Schellhase, Purdue University; Monica Miller, Purdue University

Students' Evaluation of Service Learning for Social Justice Teacher Education

Eric Dickens, Michigan State University

Evidence of Student Learning When the Community Is the Classroom

George Daniels, University of Alabama; Mark R. Wilson, Auburn University

Student and Community Partner Expectations for Effective Community-Engaged Learning Partnerships

Holly Stack-Cutler, University of Alberta; Sara Dorow, University of Alberta

Liberty Hyde Bailey Scholars: Learning from the Inside-Out

Janice Hironaka, Michigan State University; Howard Person, Michigan State University; Pat Crawford, Michigan State University

Long- and Short-term Effects of Peer-Facilitated Service-Learning

Joseph Galura, University of Michigan

Understanding Civic Engagement Through Service and Learning

Mary Hutchinson, Pennsylvania State University; Karen Kackley-Dutt, Pennsylvania State University;

Nick Accordino, Pennsylvania State University; Vinod Jeyaretnam, Pennsylvania State University

Assessing Re-Entry Culture Shock Following an International Pharmacy Practice Experience

Monica Miller, Purdue University; Ellen Schellhase, Purdue University

Transformative Experiences of Study Abroad: Engagement, Instructor-Led and Immersion Programs

Natalie Graham, Michigan State University; Pat Crawford, Michigan State University

Engaging Undergraduates with the University's Public Service and Outreach Mission

Paul Matthews, University of Georgia; Shannon O. Wilder, University of Georgia

Examining Successful Professional Development Experiences for Black Male Preservice Teachers

Roy Jones, Clemson University; Lamont A. Flowers, Clemson University; Winston E. Holton, Clemson University

Technology

Senior Citizens and their Use of Internet for Community Engagement

B. Joon Kim, Indiana University-Purdue University Fort Wayne

Developing Appropriate Technology for Honduras in a Service-Learning Program

Gregory Bixler, Ohio State University; Roger Dzwonczyk, Ohio State University; Miriam R. Simon, Ohio State University

Using Technology to Expand Engagement Capacity

Julia Storberg-Walker, North Carolina State University; Diane Chapman, North Carolina State University

Deep Culture and Social Media: The Changing Face of Engagement

Molly Engle, Oregon State University; Chris La Belle, Oregon State University

Youth Definitions of Healthy Sexuality: Implications for Social Technology Use

Terrance Campbell, YOUR Center; Allison Kimmel, University of Michigan; Daniel Kruger, University of Michigan

Long-Term Engagement by Design

William Oakes, Purdue University

Impact of Software Engineering Service Learning Capstone Project to Community

Wook-Sung Yoo, Fairfield University; Jennifer Nicole Lawlor, Fairfield University

Using Technology for Engagement with STEM Students with Disabilities

Margaretha Izzo, Ohio State University; John M. Flach, Wright State University; Christopher Andersen, Ohio State University

Poster Session 2

Monday, October 3

4:15 p.m. - 6:15 p.m.

Room: Big Ten C

Cultural Preservation

Community Leadership and Capacity Building: Using University Resources/Students as Consultants to Build Community Capacity

Ela Kakde, University of Wisconsin - Extension

Civic Engagement through Emergency Management

Elinor Madigan, Pennsylvania State University - Schuylkill Campus

What a Disaster: Developing Sustainable Care Kits for Elders

Gina Peek, Oklahoma State University; Lindsey Miner, Oklahoma State University

Higher Education Building Community Leaders: Cooperative Extension and Archway Partnership

Joann Milam, University of Georgia; Laura Bland Gillman, University of Georgia

Leveraging University Resources with Local Knowledge to Create Comprehensive Plans

Michael Dougherty, West Virginia University

From Engaged Partners to Successful Outcomes: The County College Experience

Molly Engle, Oregon State University; **Deborah J. Maddy**, Oregon State University; **Laura Cleland**, Association of Oregon Counties

Economic and Workforce Development

Homegrown Alabama: Fostering Local Relationships at University of Alabama

Andrea Mabry, University of Alabama

Southern Sundays: Recipes for Successful University, School and Community Engagement

Anne Thompson, Clay County School; **Tommie Smith Syx**, University of Alabama

Entrepreneurship Empowers Everyone

Annette Watters, University of Alabama; **Tommie Smith Syx**, University of Alabama

Exploring Competencies for Manufacturing Education Partnership (MEP) Centers

Diane Chapman, North Carolina State University; **Kate G. Guerdatt**, North Carolina State University

The Out Migration of Youth from Rural Areas

Jason Hedrick, Ohio State University; **Greg Homan**, Wright State University; **Jeff Dick**, Ohio State University; **Mark D. Light**, Ohio State University

Open Campus and Lifelong Learning in Oregon

Jeff Papke, Oregon State University; **Jeff Sherman**, Oregon State University

ECU Community Enhancement and Economic Transformation Initiative (CEETI)

Kenny Flowers, East Carolina University

Designing a Research Based Community Partnership in Digital Literacy

Patricia J. Slagter van Tryon, East Carolina University; **Theresa Barefield**, Pitt County Literacy Volunteers

Expanding the Land Grant Mission: Partnering with Community Colleges

Thomas Smith, Michigan State University

Education

One Hen: Teaching Microfinance through Problem-Based Service-Learning

Annie Whitlock, Michigan State University; **Amma Sefa-Dedeh**, One Hen, Inc.

Mathematics Gives You the Edge!

Dennis Ikpe, University of South Africa

Toward a Graduate Engaged Scholars Academy: An Evidence-based Evolution

Erik Froborg, University of New Hampshire; **Ruth Varner**, University of New Hampshire; **Chelsea Corr**, University of New Hampshire

Evaluating Instructional Delivery Methods in Entomological Outreach

Faith Weeks, Purdue University

MSU Detroit Outreach Through Early Childhood Music and Music Therapy

Jody Stark, Michigan State University; **Julie Derges Kastner**, Michigan State University

Wisconsin Leads: A New Collaboration in K-12 Professional Development

Kevin Niemi, University of Wisconsin – Madison; **Jack Jorgensen**, University of Wisconsin – Madison; **Phillip Caldwell II**, University of Wisconsin – Madison; **Sarah J. Adumat**, University of Wisconsin – Madison; **Tim J. Peterson**, Madison Metropolitan School District

Global Institute: Ohio Educators Going Global

Mary Trube, Ohio University

Partnership: Hart County Schools, University of Georgia College of Education, Archway Partnership

Matt Bishop, University of Georgia; **Sue Chapman**, University of Georgia; **Ilka McConnell**, University of Georgia; **Jerry Bell**, Hart County Schools; **Janna Dresden**, University of Georgia

Seeds of Science: Field Trips for 21st Century Learning

Norm Lownds, Michigan State University; **Jessica Wright**, Michigan State University

Structuring Summer Forums: Laboratories for Civic Engagement

Susan Printy, Michigan State University

Learning to Count: Context and Contingencies in Education

Timothy Shaffer, Cornell University; **Thomas G. Archibald**, Cornell University

Assets Based Community Development in a Rural School Community

Tracy Carpenter-Aeby, East Carolina University; **Victor G. Aeby**, East Carolina University; **Victoria C. Aeby**, East Carolina University

Process Evaluation for Leadership and Life-Skills Academy in Middle School

Tracy Carpenter-Aeby, East Carolina University; **Victor G. Aeby**, East Carolina University; **Jacqueline Coleman-Carmon**, East Carolina University; **Danielle Harmon**, East Carolina University; **Richelle Smallwood**, East Carolina University

Families

Length of Unemployment and Underemployment and Marital Satisfaction

Amanda Guinot Talbot, Michigan State University

Reaching Multicultural Families: Summer Lunch Bunch

Theresa Danielson Wimann, University of Wisconsin – Extension; **Susan E. Nagelkerk**, University of Wisconsin – Extension

Health and Health Care

A Multidisciplinary Approach of Community Service: Communication of Health-Related Issues

Alice Crume, Kent State University at Tuscarawas; **Lisa Beltz**, Kent State University at Tuscarawas

A Health Needs Assessment Guides a Community Translational Genomics Project

Emilie Dykstra, Michigan State University; **Debra L. Schutte**, Michigan State University; **Jamie L. Rivard**, Michigan State University; **Rachel Fisher**, Michigan State University; **Brian C. Schutte**, Michigan State University

Mapping a Strategic Plan for Health: Community-Based Participatory Research with Underserved, Low-income, Urban Neighborhoods

Gail Zandee, Calvin College

Indiana University Student Outreach Clinic: An Interprofessional Service-Learning Model

Gregory Martens, Indiana University; **Janice Lin**, Indiana University; **Steve Kirchhoff**, Indiana University

Engagement and Recruitment Strategies in a Community-Based Translational Genomics Project

Jamie L. Rivard, Michigan State University; **Emilie Dykstra**, Michigan State University; **Rachel A. Fisher**, Michigan State University; **Brian C. Schutte**, Michigan State University; **Debra L. Schutte**, Michigan State University

Indiana University Student Outreach Clinic: Engaged Learning through a Student-Run Free Clinic

Janice Lin, Indiana University; **Gregory Martens**, Indiana University; **Charles B. Goodwin**, Indiana University; **Aliese Sarkissian**, Indiana University

Missouri's Family Nutrition Education Programs: Relationships to Ensure Program Success

Jo Britt-Rankin, University of Missouri; **Candance E. Gabel**, University of Missouri

Farming on the Spectrum: Engaging Rural Communities with Social Farming

Lisa Szymecko, Michigan State University

Arthritis Screenings in Rural Farming Communities

Margaret Teaford, Ohio State University; **Sharon R. Flinn**, Ohio State University

Screening for Health Hazards: A Partnership with the Healthy Homes Coalition of West Michigan

Sergio da Silva, Calvin College

The Farm Worker Family Health Program: Pharmacy Student Perception

Trina von Waldner, University of Georgia; **Deanna W. McEwen**, University of Georgia

Integrating Coordinated School Health to Prevent Suspension and Academic Failure

Victor G. Aeby, East Carolina University; **Tracy Carpenter-Aeby**, East Carolina University

Natural and Built Environments

Research and Restoration: Student Engagement in the Plaster Creek Watershed

David Warners, Calvin College

Collaborations between Engineering Faculty/ Students and the City Utilities

Dong Chen, Indiana University – Purdue University Fort Wayne

Service-Learning in a First-Year Engineering Design Course

Edmund Tsang, Western Michigan University; **Darrell Harden**, Michigan Department of Transportation

Re-Animation: Odd Fellows Cemetery and Potters Field Rehabilitation Project

Katherine Ambroziak, University of Tennessee – Knoxville

Four Transit Villages: A Collaborative Design and Development

Thomas Davis, University of Tennessee – Knoxville

Pre-College Programs

Auburn Family University: Addressing College Access Through K-12 Family Collaborations

Christiana Russell, Auburn University; Ralph S. Foster, Auburn University; Royrickers Cook, Auburn University

The Michigan College Advising Corps: College Advisers in High Schools

Christopher Rutherford, University of Michigan

Think College: Increasing College Access for First Generation Students

Emily Nemeth, Ohio State University

Using Interactive Theatre to Promote Pathways to Higher Education

Helki Jackson, University of Michigan

CAP: Creating a College-Going Culture Through a New Mentoring Model

Kri Burkander, Michigan State University; Julie N. Gold, Michigan State University; Clay Braggs, Michigan State University

Outreach from Higher Education to K-12: Engaging Engineering Grad Students

Lisa Grable, North Carolina State University; Leda Lunardi, North Carolina State University

Humanities Programming at an Urban University

Philip Joseph, University of Colorado Denver; Janet Lopez, University of Colorado Denver

Welcome to Greater Lansing



2011 National Outreach Scholarship Conference

October 2-4, 2011

**Kellogg Hotel & Conference Center
MSU Campus, East Lansing**

For more details visit:
www.lansing.org/nosc



Come Explore Greater Lansing!

There is so much to see and do in Michigan's Capital City. Download the FREE Greater Lansing Mobile App and turn your smartphone into a location-aware travel guide full of maps, attractions and more!

<http://m.lansing.org>



Download our mobile app!



- View Calendar of Events
- Find Accommodations
- Locate Dining & Fun Nearby
- Much More!



Leadership and Professional Development for Engaged Scholarship



**Service-Learning Director
Leadership Institute**

February 28–March 1, 2012

**Engagement Academy
for University Leaders**

June 4-8, 2012

Fundraising for Engagement

June 8-10, 2012

**Measuring & Monitoring
for Engagement**

April 11-13, 2012

Sponsored by: 

Learn from world-class faculty to develop your institutions plan for engagement, and interact with national leaders and gain new insight, strategies, for proven results.

Location: The Historic Hotel Roanoke & Conference Center • Roanoke, Virginia

www.cota.vt.edu/engagementacademy/

For more information, contact:

Jeri Childers, Fellow, Virginia Tech's Center for Organizational and Technological Advancement at jlc@vt.edu

Endorsed by:



Acknowledgments

2011 National Outreach Scholarship Conference

Michigan State University Planners

Core Planning Committee

Burton A. Bargerstock

Director, Communication and Information Technology
Co-Director, National Collaborative for the Study of
University Engagement
University Outreach and Engagement

Julie Crowgey

Event Coordinator, Communication and Information Technology
University Outreach and Engagement

Denyse Ferguson

Former President and Chief Executive Officer
Lansing Economic Area Partnership

Hiram E. Fitzgerald

Associate Provost for University Outreach and Engagement
University Distinguished Professor, Psychology

Ghada Georgis

Assistant Director, Communication and Information Technology
University Outreach and Engagement

Peggy Roberts

Coordinator, Power of We Consortium

Michelle S. Rodgers

Associate Director, Michigan State University Extension

Logistics Team

Burton A. Bargerstock
Carl Bussema III
Amy Byle
Julie Crowgey
Mike Davis
Lynne Devereaux
Sara Devereaux
JoDee Fortino
Glenda Gatewood
Kenzie Gatewood
Ghada Georgis
Catherine Gibson
Katherine Gross
Cindy Helms
Carla Hills
Linda Chapel Jackson
Paul Phipps
Joyce Pinckney
Carl Raymond
Brad Smith
Mark Szymczak
Mary Taylor

Content Team

Advisors

William S. Davidson
Patricia Farrell
Pamela Whitten

Plenary Planning

Angela Waters Austin
Matthew Birbeck
Robert Brown
Daniel Clay
William Davidson
C. Kurt Dewhurst
Deborah DeZure
Diane M. Doberneck
Frank Fear
Christine Geith
Erik Goodman
Jeffrey Grabill
Geoffrey Habron
Deanne Hamilton
David Hollister
Scott Loveridge
Miles McNall
Gary Morgan
Jim Paparella
Tremaine Phillips
Phillip Reed
Jeffrey Riedinger
Kirk Riley
Bryan Ritchie
Cheryl Rosaen
Kate Tykocki
Lela Vandenberg
Laurie Van Egeren
David Wiener
Wynne Wright

2011 National Outreach Scholarship Conference

Emerging Engagement Scholars Workshop

Planning Committee

Laurie A. Van Egeren, Co-Chair
Michigan State University

Lisa Townson, Co-Chair
University of New Hampshire

Jessica Averitt
University of Alabama

Eric Bailey
Michigan State University

Burton A. Bargerstock
Michigan State University

Kate Guerdat
University of Georgia

Lisa Marshall
North Carolina State University

Susan Melsop
Ohio State University

Neivin Shalabi
University of Denver

Sandra Sydnor-Bousso
Purdue University

James Woodell
Pennsylvania State University

2011 Participants

Jennifer Anderson
Michigan State University

Lisa Bates
Iowa State University

Stephanie Budhai
Drexel University

Maria De Moya
North Carolina State University

Lina Dostilio
Duquesne University

Rebecca Foco
Virginia Commonwealth University

Karen Foli
Purdue University

Jessica Gardon Rose
Central Michigan University

Jo Latimore
Michigan State University

Tiffany McDonald
University of Denver

Paula Miller
Michigan State University

Casey Mull
University of Georgia

Emily Nemeth
Ohio State University

Traci Rider
North Carolina State University

Kristine Ronan
University of Michigan

Timothy Shaffer
Cornell University

Sandra Spoelstra
Michigan State University

Jody Stark
Michigan State University

Julie Taylor
University of Alabama

Jeena Williams
University of Alabama

Heng-Chieh Wu
Michigan State University

Marissa Yandall
University of Denver

2011 National Outreach Scholarship Conference

Outreach and Engagement Staff Workshop

Planning Committee

Katherine Loving, Chair
University of Wisconsin – Madison

Jessica Gagne Cloutier
East Carolina University

Susan Harden
University of North Carolina at Charlotte

Shawn Moore
East Carolina University

Todd Mortensen
Appalachian State University

Kathay C. Rennels
Colorado State University

Beth Tryon
University of Wisconsin – Madison

2011 National Outreach Scholarship Conference

National Implementation Committee

Burton A. Bargerstock, Chair
Michigan State University

Theodore Alter
Pennsylvania State University

Janet Conner
Pennsylvania State University

Julie Crowgey
Michigan State University

Hiram E. Fitzgerald, ex officio
Michigan State University

Birgit L. Green
Texas Tech University

Janet F. Griffith
University of Alabama

Bridget Julian
Colorado State University

Trish Kalivoda
University of Georgia

Katherine Loving
(OESW Planning Committee Chair)
University of Wisconsin – Madison

Deborah Maddy
Oregon State University

Edward Mullins
University of Alabama

Rosemary Potter
University of Wisconsin – Extension

Connie Robertson
University of Kentucky

R. Dale Safrit
(Past Chair)
North Carolina State University

Chippewa Thomas
Auburn University

Laurie A. Van Egeren
(EESW Planning Committee Chair)
Michigan State University





Anu Varsava
University of Alberta

Candiss Vibbert
Purdue University

Craig D. Weidemann, ex officio
Pennsylvania State University

Kellogg Hotel & Conference Center

Floor Plan

-  Elevator
-  Restaurant
-  Parking
-  Women's Restroom
-  Men's Restroom

Lobby Level

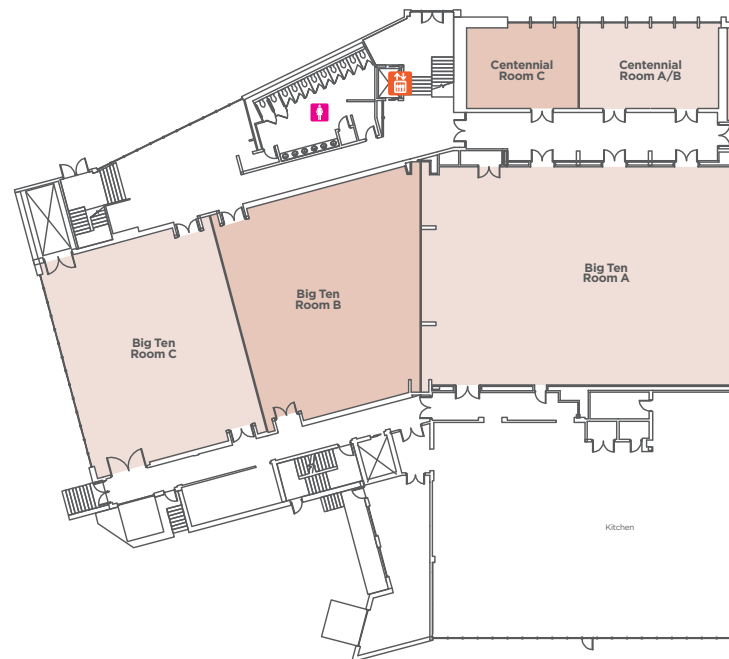

Ground Level



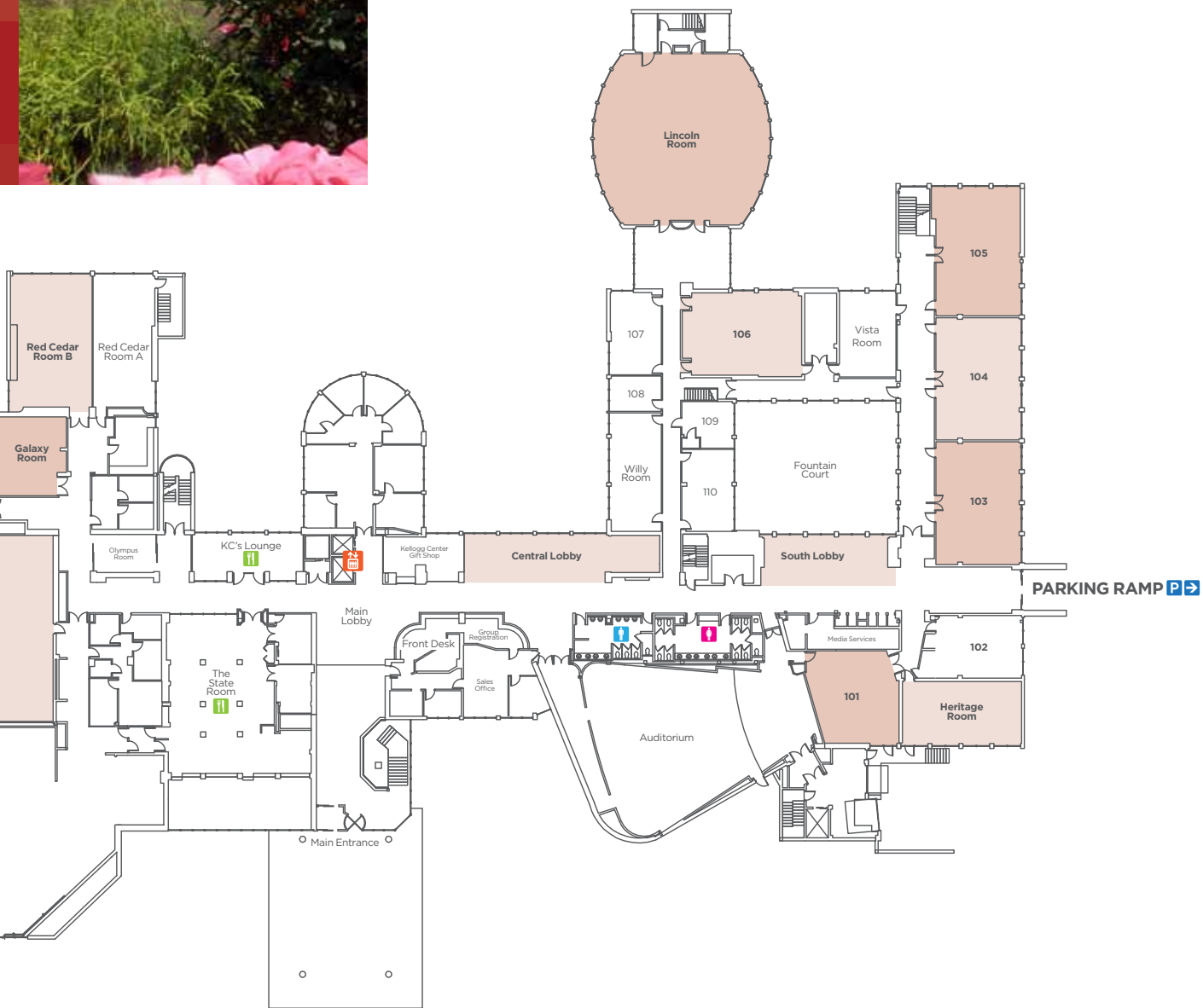

REGISTRATION ROOM
ROOM 93 ON GROUND LEVEL

2011 National Outreach Scholarship Conference

Venue, Hotels, and Area Map

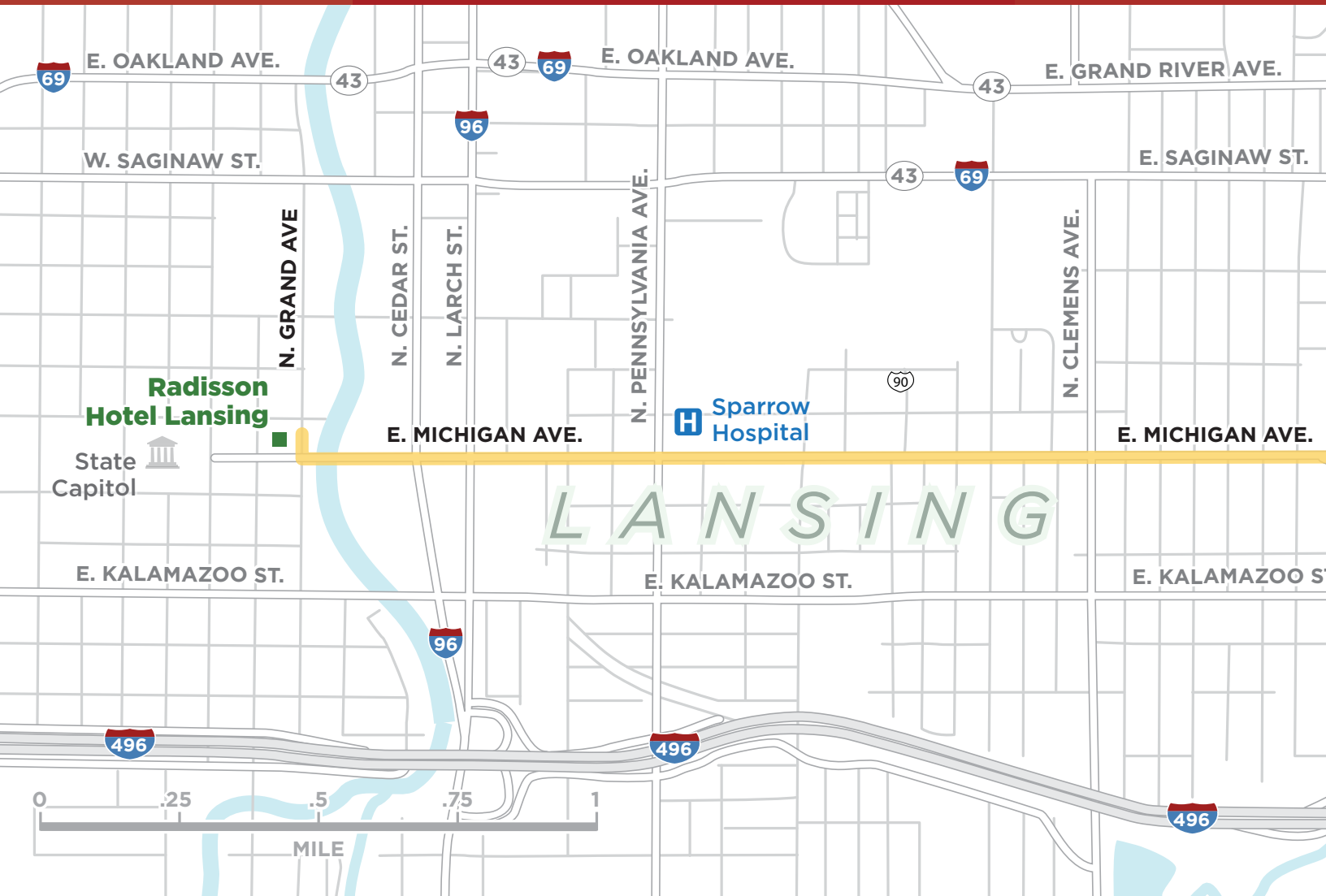

INDICATES ROUTE FROM RADISSON HOTEL LANSING
TO KELLOGG HOTEL & CONFERENCE CENTER

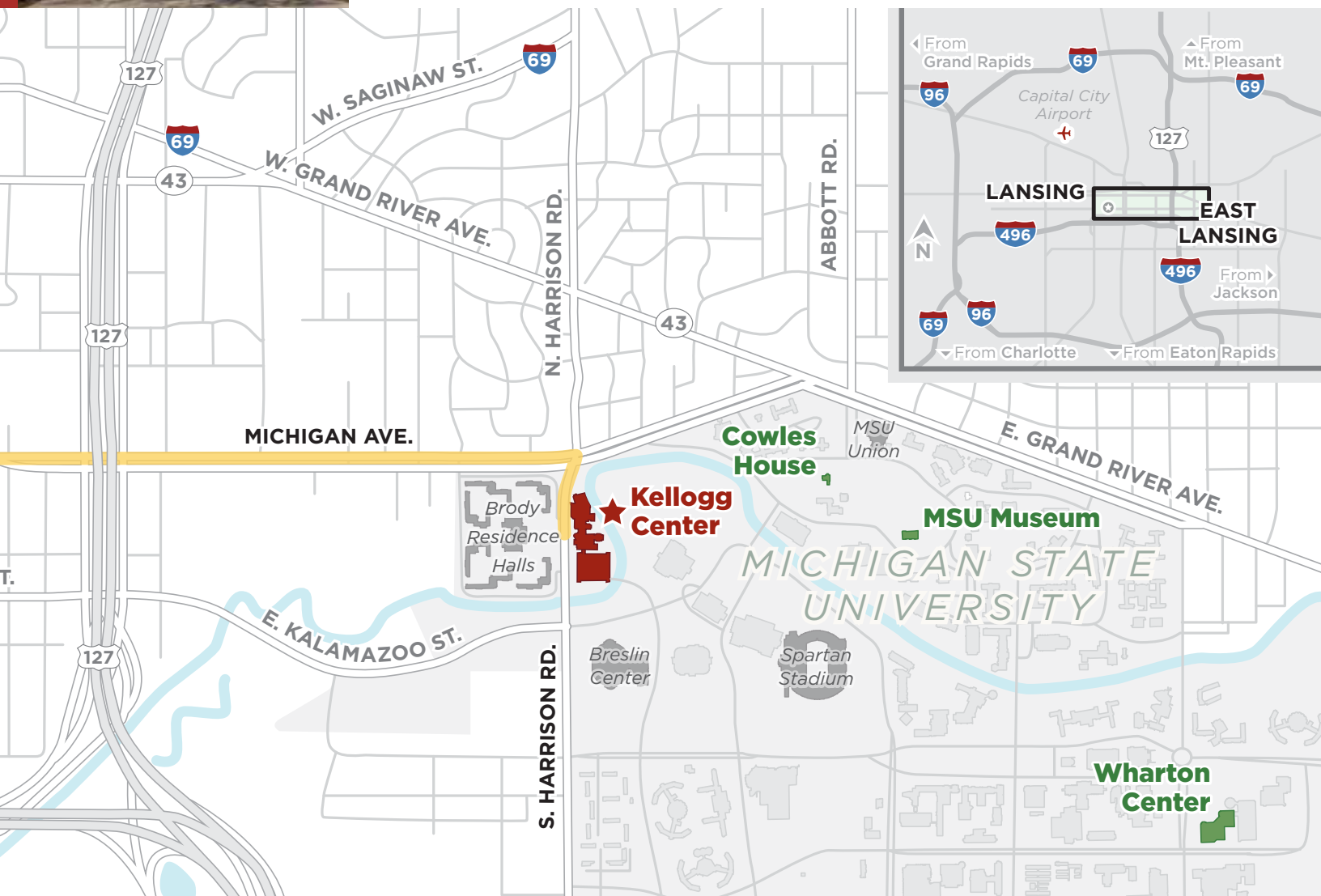

2012 NATIONAL OUTREACH SCHOLARSHIP CONFERENCE

September 30-October 3, 2012 www.NOSC2012.ua.edu

THE UNIVERSITY OF ALABAMA



partner

change

inspire